

ROOF SPECIALTIES MEF-AE1 RIGID CONDUIT FLASHING

DESCRIPTION

Thaler MEF-AE1 Rigid Conduit Flashing consists of a metal flashing sleeve with integral deck flange, pre-molded urethane insulation liner, EPDM Triple Pressure Grommet Seal, and EPDM Base Seal. A one piece flashing will be supplied for full size diameters (e.g. 2" (51 mm), 3" (76 mm)), etc. and for fractional sizes, a flashing and screw fastened removable cap will be supplied. Available in aluminum, copper, and stainless steel.

Diameter: Suitable for conduit diameters from 7/64" (2.5 mm) up to 6" (152 mm). See Sizes Chart on reverse side of page. Height: Available 12" (305 mm) or 18" (457 mm) high.

Prominent Features: Maintenance free. Never needs caulking. See Thaler EPDM Flashing Seals literature.

Options: See Sizes Chart on reverse side of page. PVC coated deck flange for PVC roof membrane. Bituminous painted deck flange for BUR and ModBit roof membrane. Split flashing (SPJ-2) is available as an alternative if sleeve cannot fit over vent stack.

RECOMMENDED USE

For rigid mechanical or electrical conduit penetrating the roof.

APPROVALS

CSA Approved to CSA B272-93 (Prefabricated Self-Sealing Roof Vent Flashings).

WARRANTY

20 year warranty against leaks, condensation and defects in materials and/or manufacture when installed in accordance with Thaler "Installation Instructions". Warranty not valid where metal components are subjected to unusually harsh corrosive environments e.g. pulp mills, mining facilities and similar applications. Stainless steel only is recommended for these installations.

MAINTENANCE

No maintenance required (maintenance free).

SPECIFICATION (Short Form)

Rigid Conduit flashing: Thaler MEF-AE1, [.064" (1.6 mm) mill finish 1100-OT alloy aluminum] [.032" (0.831 mm) 24 oz. copper] [.031" (0.79 mm) 22 ga. Type 304 stainless steel] flashing sleeve with integral deck flange, [12" (305 mm)] [18" (457 mm)] high; with pre-molded urethane insulation liner, EPDM Triple Pressure Grommet Seal, and EPDM Base Seal; diameter to suit rigid conduit; [PVC coated deck flange] [bituminous painted deck flange]; manufactured by Thaler Metal Industries, 1-800-387-7217 (Mississauga, Ontario, Canada) or 1-800-576-1200 (New Braunfels, TX), installed as per manufacturer's written instructions. Provide 20 year warranty against leaks, condensation and defects in materials and/or manufacture.

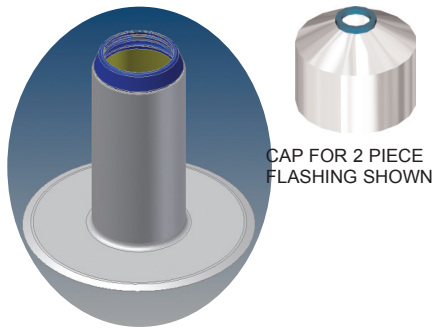
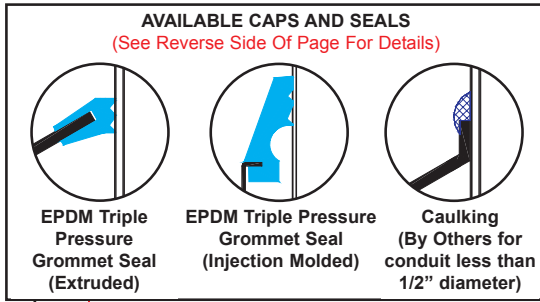

EPDM TRIPLE PRESSURE GROMMET SEAL

When ordering, add -12, or -18 to the end of model number to specify a 12" or 18" high flashing (e.g. MEF-1-A-12)

THALER MEF-AE1 RIGID CONDUIT FLASHING. AVAILABLE IN ALUMINUM, COPPER OR STAINLESS STEEL

URETHANE INSULATION PRE-MOLDED TO INNER SIDE OF SLEEVE

CONVENTIONAL ROOFING ILLUSTRATED

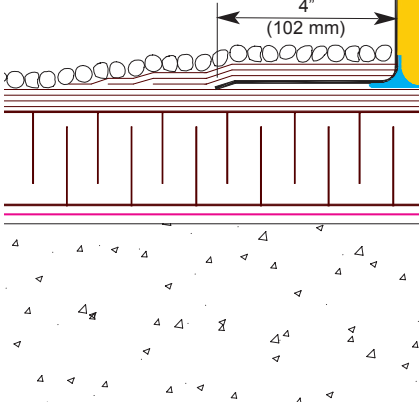

AVAILABLE TO SUIT RIGID CONDUIT FROM .84" (21 mm) TO 6.625" (168 mm)

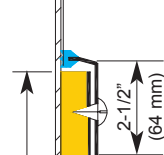

TWO PIECE FLASHING FOR FRACTIONAL SIZE CONDUIT (CAP FASTENED USING TWO STAINLESS STEEL SCREWS)

EPDM BASE SEAL BONDED TO METAL SLEEVE (SEE THALER EPDM FLASHING SEALS LITERATURE)

EMBED DECK FLANGE IN LAYER OF PLASTIC CEMENT

CONVENTIONAL ROOFING ILLUSTRATED

MECHANICAL OR ELECTRICAL SERVICE CONDUIT (WIRING, GASES, PROCESS PIPING, FLUIDS, OR SIMILAR (BY OTHERS))

CONCRETE DECK

STEEL DECK

MEF-AE1 RIGID CONDUIT FLASHING

Patent Pending

INSTALLATION

"Installation Instructions" are provided with every Thaler product. Essentially, Thaler MEF-AE1 Flashings are installed by placing the flashing over the conduit or alternatively feeding the conduit through after the flashing has been placed. In either case, install flashing as follows:

BUR: Set deck flange in layer of plastic cement and flash in with 3 overlapping layers of felt flashing.

ModBit: Torch membrane until bitumen is fluid and set flange into fluid. Flash in flange with two overlapping layers of ModBit and seal with asphalt sealer. Do not overheat (melt) EPDM Base Seal.

Single Ply: Set deck flange in layer of membrane adhesive and extend single ply up sleeve to highest elevation possible and clamp membrane to Hot Pipe Flashing. Note: for PVC membrane, specify PVC coated flashing by adding suffix P to end of model number, e.g. MEF-AG1-P; weld roofing to deck flange using PVC torch.

Precautions: Apply an asphaltic or other type protective coating to aluminum flashing to a height of 2" (51 mm) above a limestone ballast to avoid corrosive reaction. Also, if coating deck flange with bituminous paint on site, allow 24 hours for drying before applying roof membrane.

Ordering and Availability: Specify material required by adding appropriate prefix to model number e.g. MEF-AE1-A for aluminum, etc. Available throughout North America. Contact Thaler for list of distributors and current cost information. Most products are readily available from stock.

Sizes Chart

This chart illustrates the different EPDM Grommet Seals and Base Seals which will be used for each size conduit, vent pipe, etc.

Trade Size	Actual Size (inches)	Actual Size (millimeters)	Grommet Supplied
1/2"	.84"	(21 mm)	B
3/4"	1.05"	(27 mm)	B
1"	1.315"	(33 mm)	B
1-1/4"	1.66"	(42 mm)	B
1-1/2"	1.9"	(48 mm)	A
2"	2.375"	(60 mm)	A
2-1/2"	2.875"	(73 mm)	B
3"	3.5"	(89 mm)	A
3-1/2"	4"	(102 mm)	A
4"	4.5"	(114 mm)	A
5"	5.563"	(141 mm)	A
6"	6.625"	(168 mm)	A

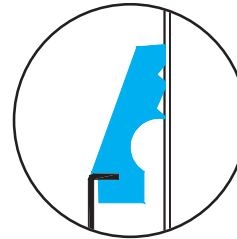

Type A
EPDM Triple
Pressure Grommet
Seal (Injection
Molded)

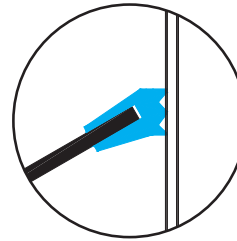

Type B
EPDM Triple
Pressure Grommet
Seal (Extruded)