

MEF-3A HOT PIPE FLASHINGS

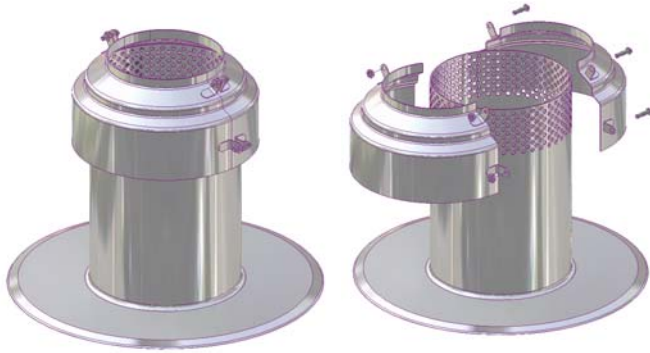

AVAILABLE TO SUIT
HOT PIPES FROM
3" (76 mm) UP TO
43" (1092 mm) DIA.

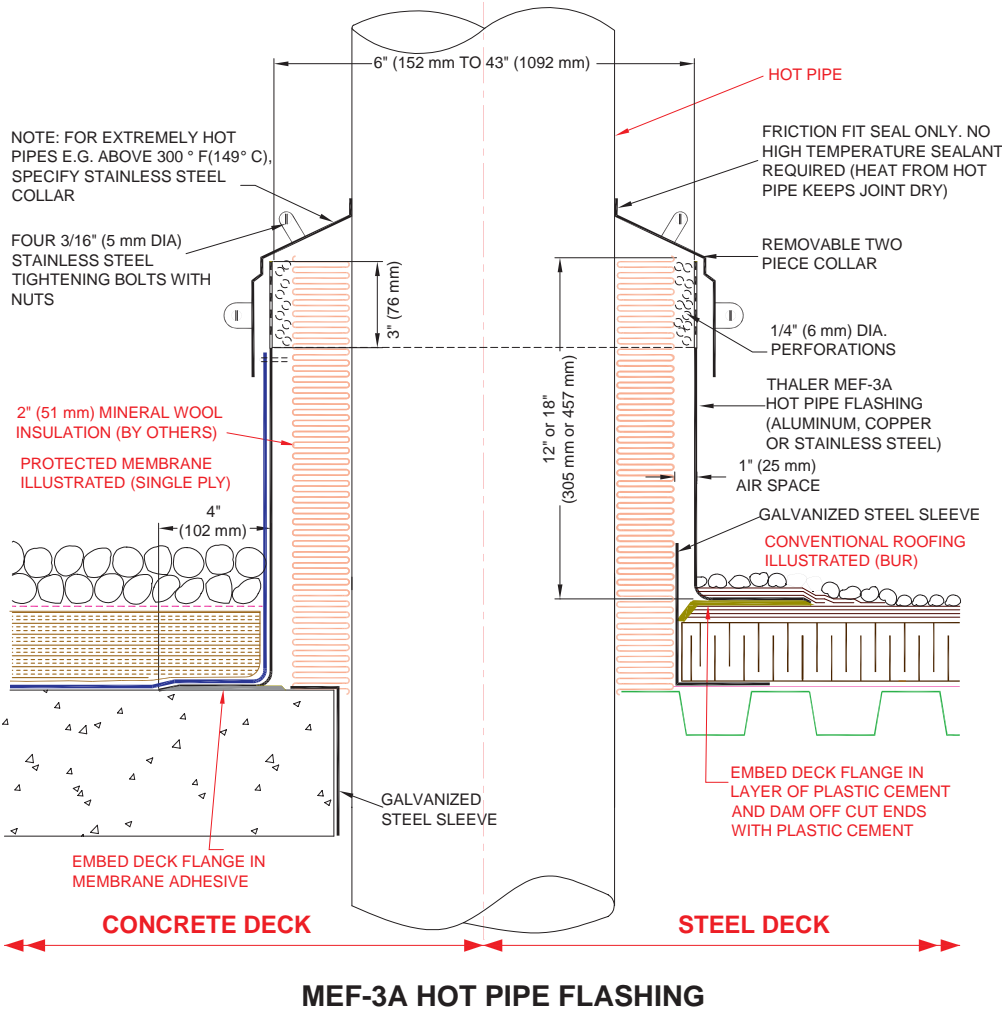

DESCRIPTION

Thaler MEF-3A Hot Pipe Flashing consists of a metal flashing sleeve with integral deck flange, and matching two piece, friction fit collar. The flashing sleeve is typically supplied 4" (102 mm) larger than the hot pipe diameter to accommodate 2" (51 mm) of mineral wool insulation (by others). The sleeve is also perforated at the top with 1/4" (6 mm) diameter holes for a height of 3" (76 mm). Available in aluminum, copper or stainless steel.

Diameter: Sleeve diameter ranges from 6" (152 mm) to 43" (1092 mm) depending on hot pipe size.

Height: Available 12" (305 mm) or 18" (457 mm) high.

Prominent Features: Maintenance free.

Options: PVC coated deck flange for PVC roof membrane. Bituminous painted deck flange for BUR and ModBit roof membrane. Split flashing (SPJ-2) is available as an alternative if sleeve cannot fit over hot pipe.

RECOMMENDED USE

For hot pipes used in connection with diesel generators, steam heating, chimney pipes and similar applications.

WARRANTY

20 year warranty against leaks, condensation and defects in materials and/or manufacture when installed in accordance with Thaler "Installation Instructions". Warranty not valid where metal components are subjected to unusually harsh corrosive environments e.g. pulp mills, mining facilities and similar applications. Stainless steel only is recommended for these installations.

MAINTENANCE

No maintenance required (maintenance free).

SPECIFICATION (Short Form)

Hot pipe flashing: Thaler MEF-3A Hot Pipe Flashing [12" (305 mm)] [18" (457 mm)] high with 1/4" (6 mm) dia. perforations at top of flashing, integral deck flange and matching two piece collar; [.064" (1.6 mm) mill finish 1100-OT alloy aluminum] [24 oz. 0.032" (0.831 mm) copper] [.031" (0.79 mm) 22 ga. Type 304 stainless steel]; diameter to suit hot pipe; galvanized steel sleeve deck protection; [PVC coated deck flange] [bituminous painted deck flange]; manufactured by Thaler Metal Industries, 1-800-387-7217 (Mississauga, Ontario, Canada) or 1-800-576-1200 (New Brunfels, TX), installed as per manufacturer's written instructions. Provide 20 year warranty against leaks, condensation and defects in materials and/or manufacture.

INSTALLATION

"Installation Instructions" are provided with every Thaler product. Essentially, Thaler MEF-3A Hot Pipe Flashings are installed by placing deck protection sleeve, wrapping the hot pipe with mineral wool insulation (by others), placing the flashing over the hot pipe, and as follows:

BUR: Set deck flange in layer of plastic cement while damming off cut ends of membrane with plastic cement and flash in with 3 overlapping layers of felt flashing.

ModBit: Torch membrane until bitumen is fluid and set flange into fluid. Flash in flange with two overlapping layers of ModBit and seal with asphalt sealer.

Single Ply: Set deck flange in layer of membrane adhesive and extend single ply up sleeve to highest elevation possible and clamp membrane to Hot Pipe Flashing. Note: for PVC membrane, specify PVC coated flashing by adding suffix P to end of model number, e.g. MEF-3A-P; weld roofing to deck flange using PVC torch.

Precautions: Apply an asphaltic or other type protective coating to aluminum flashing to a height of 2" (51 mm) above a limestone ballast to avoid corrosive reaction. Also, if coating deck flange with bituminous paint on site, allow 24 hours for drying before applying roof membrane.

Ordering and Availability: Available throughout North America. Contact Thaler for list of distributors and current cost information. Most products are readily available from stock.