

Model	Conduit Size	Bend Radius	Pipe I.D.	Pipe O.D.	Base Plate
MEF-2A	.25" to 1.32"	7.5" (191 mm)	2.125" (55 mm)	2.375" (60 mm)	.1875 x 10 x 12" (5 x 254 x 305 mm)
MEF-2A1	1.32" to 2"	12" (305 mm)	3.260" (83 mm)	3.5" (89 mm)	.25 x 12 x 17" (6 x 305 x 432 mm)
MEF-2A2	2" to 4"	20" (508 mm)	6.357" (161 mm)	6.625" (168 mm)	.375 x 14 x 27" (6 x 356 x 686 mm)

SEE REVERSE SIDE OF PAGE FOR DETAILS.

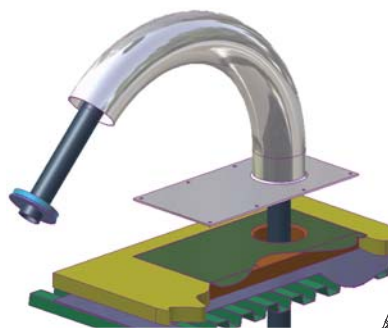

3D-VIEW SHOWING MEF-2A1 MODEL

THALER MEF-2A LIQUID TIGHT FLEXIBLE CONDUIT FLASHING

EPDM BASE SEAL, BONDED TO METAL BASE (SEE THALER EPDM FLASHING SEALS LITERATURE)

#14 x 2", COUNTERSUNK STAINLESS STEEL SCREWS (QUANTITY DIFFERS BETWEEN MODELS). 4" (102 mm)

WOOD BLOCKING TO MATCH DECK FLANGE WIDTH, LENGTH AND INSULATION THICKNESS (BY OTHERS)

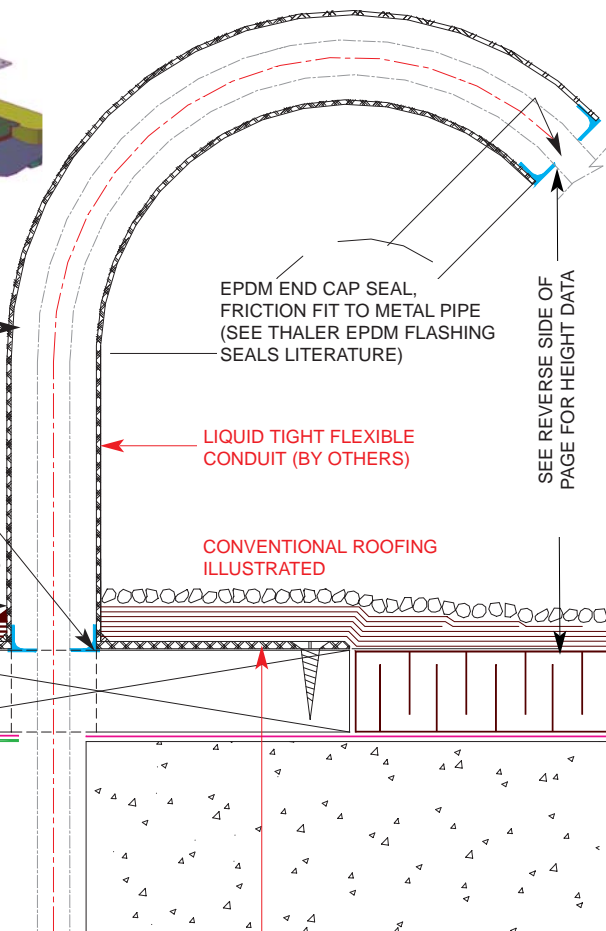

MEF-2A/MEF-2A1/MEF-2A2 LIQUID TIGHT FLEXIBLE CONDUIT FLASHING

Patented

INSTALLATION

"Installation Instructions" are provided with every Thaler product. Essentially, Thaler flexible conduit flashings are installed by placing the flashing over the conduit or alternatively feeding the conduit through after the flashing has been placed. In either case, install flashing as follows:

BUR: Set deck flange in layer of plastic cement and flash in with 3 overlapping layers of felt flashing.

ModBit: Torch membrane until bitumen is fluid and set flange into fluid. Flash in flange with two overlapping layers of ModBit and seal with asphalt sealer. Do not overheat (melt) EPDM Base Seal.

Single Ply: Set deck flange in layer of membrane adhesive and extend single ply up sleeve to highest elevation possible and clamp membrane to flashing. Note: for PVC membrane, specify PVC coated flashing by adding suffix P to end of model number, e.g. MEF-2A-P; weld roofing to deck flange using PVC torch.

Precautions: Apply an asphaltic or other type protective coating to aluminum flashing to a height of 2" (51 mm) above a limestone ballast to avoid corrosive reaction. Also, if coating deck flange with bituminous paint on site, allow 24 hours for drying before applying roof membrane.

Ordering and Availability: Available throughout North America. Contact Thaler for list of distributors and current cost information. Most products are readily available from stock.

ROOF SPECIALTIES
MEF-2A/MEF-2A1 /
MEF-2A2
LIQUID TIGHT
FLEXIBLE CONDUIT
FLASHING

DESCRIPTION

Thaler MEF-2A, MEF-2A1 and MEF-2A2 Liquid Tight Flexible Conduit Flashings consist of a gooseneck shaped aluminum flashing pipe sleeve with integral deck flange, EPDM End Cap Seal and EPDM Base Seal. Each seal is provided with one or more holes, for liquid tight flexible steel conduit or for a small diameter auxiliary wire for air handling units (optional).

Diameter: Flexible conduit from 1/4" (6 mm) up to 4" (102 mm) nominal size can be accommodated. See Sizes Chart on reverse side of page.

Height: 12" (305 mm) for MEF-2A and MEF-2A1; 20" (508 mm) for MEF-2A2.

Prominent Features: Condensation free. Never needs caulking (see Thaler EPDM Flashing Seals literature).

Options: Thaler flashing for inverted roofs e.g. 6" (152 mm) or more additional height. Auxiliary wire hole in both EPDM End Cap Seal and Base Seal, (see Thaler EPDM Flashing Seals literature). PVC coated deck flange for PVC roof membrane. Bituminous painted deck flange for BUR and ModBit roof membrane. Split flashing (SPJ-2) is available as an alternative if sleeve cannot fit over conduit.

RECOMMENDED USE

For liquid tight flexible steel conduit penetrating the roof for electrical services.

APPROVALS

CSA Approved to CSA B272-93 (Prefabricated Self-Sealing Roof Vent Flashings).

WARRANTY

20 year warranty against leaks, condensation and defects in materials and/or manufacture when installed in accordance with Thaler "Installation Instructions". Warranty not valid where metal components are subjected to unusually harsh corrosive environments e.g. pulp mills, mining facilities and similar applications. Stainless steel only is recommended for these installations.

MAINTENANCE

No maintenance required (maintenance free).

SPECIFICATION (Short Form)

Flexible Conduit flashings: Thaler [MEF-2A standard 12" (305 mm)] [MEF-2A1 standard 12" (305 mm)] [MEF-2A2 standard 20" (508 mm)] high flashing; 6061-T4 aluminum with mill finish; to CSA B272-93; with EPDM End Cap Seal and Base Seal; EPDM Seals with hole to suit ____ dia. liquid tight flexible conduit [and air handling unit auxiliary wire hole to suit ____ dia. wire]; [PVC coated deck flange] [bituminous painted deck flange]; manufactured by Thaler Metal Industries, 1-800-387-7217 Mississauga, Ontario, Canada) or 1-800-576-1200 (New Braunfels, TX), installed as per manufacturer's written instructions. Provide 20 year warranty against lecondensation and defects in materials and/or manufacture.

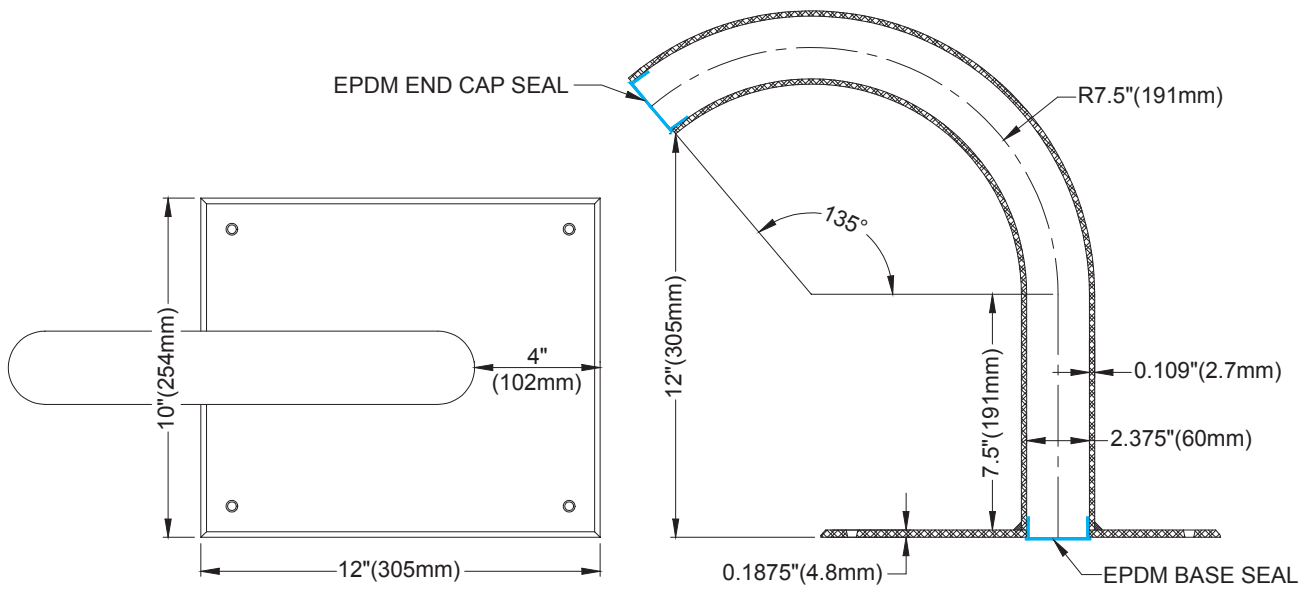

MODEL MEF-2A

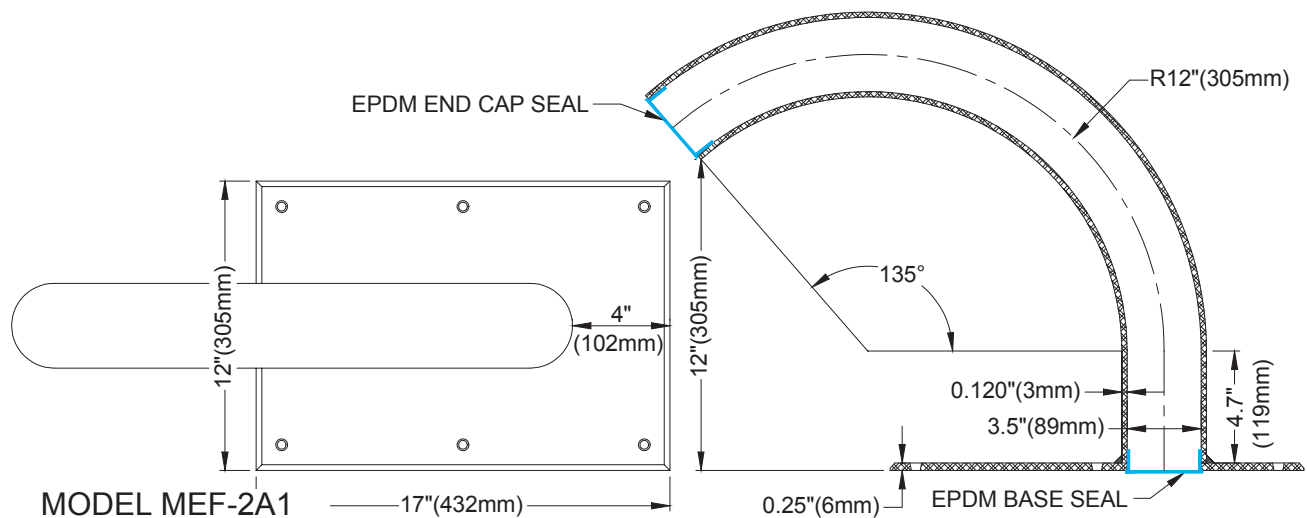

MODEL MEF-2A1

NOTE:
SPECIFY HIGHER DIMENSION FOR
INVERTED ROOFS E.G. 6" (152 mm)
OR MORE ADDITIONAL HEIGHT.

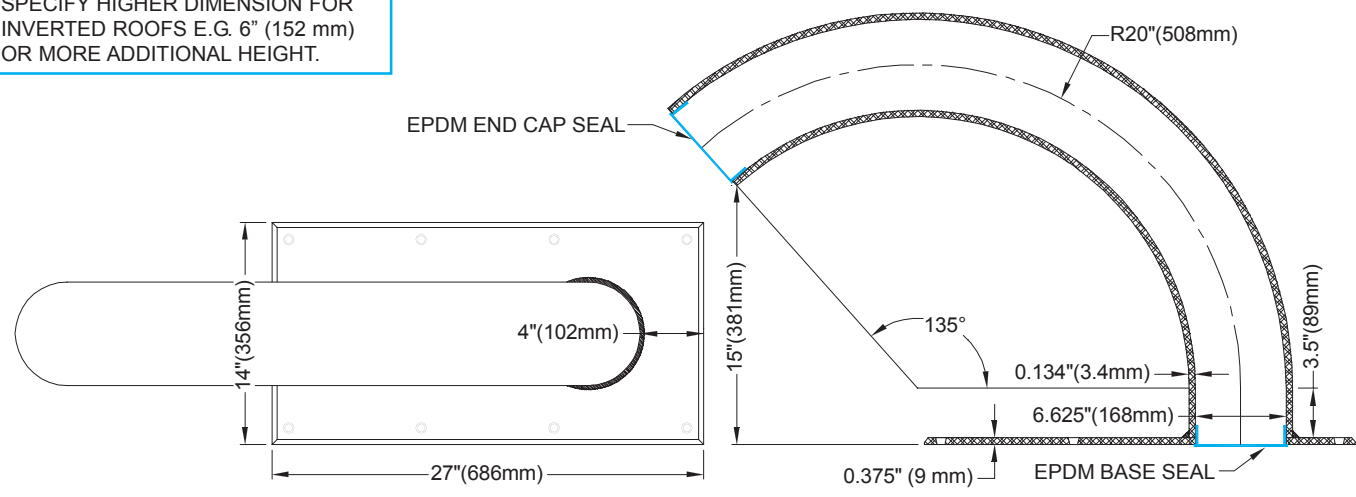

MODEL MEF-2A2