

# ROOF SPECIALTIES MEF-1 RIGID CONDUIT FLASHING

## DESCRIPTION

Thaler MEF-1 Rigid Conduit Flashing consists of a metal flashing sleeve with integral deck flange, EPDM Base Seal, removable cap, and a choice of grommet seals depending on the size of the rigid conduit being employed. Available aluminum, copper, and stainless steel.

Diameter: Sleeve diameter ranges from 3-1/8" (79 mm) to 7-1/2" (191 mm) depending on conduit size. Conduit diameters that can be accommodated range from 1/4" (6 mm) to 6" (152 mm) O.D. See Sizes Chart on reverse side of page.

Height: 12" (305 mm) or 18" (457 mm) high.  
**Prominent Features:** Condensation free. EPDM seals will not allow moisture to penetrate flashing (see Thaler EPDM Flashing Seals literature). Note: exception to this feature is the caulked cap for 1/4" and 3/8" (6 mm and 10 mm) diameter conduit which are not supplied with an EPDM Triple Pressure Grommet Seal; however should moisture be able to penetrate the caulking (in the event the caulking is not maintained) the EPDM Base Seal would prevent any accumulated moisture from penetrating the ceiling space below.

**Options:** See Sizes Chart on page C-9. PVC coated deck flange for PVC roof membrane. Bituminous painted deck flange for BUR and ModBit roof membrane. Split flashing (SPJ-2) is available as an alternative if sleeve cannot fit over conduit.

## RECOMMENDED USE

For rigid conduit penetrating the roof.

## APPROVALS

CSA Approved to CSA B272-93 (Prefabricated Self-Sealing Roof Vent Flashings).

## WARRANTY

20 year warranty against leaks, condensation and defects in materials and/or manufacture when installed in accordance with Thaler "Installation Instructions". Warranty not valid for caulked cap or where metal components are subjected to unusually harsh corrosive environments e.g. pulp mills, mining facilities and similar applications (stainless steel only is recommended for these installations).

## MAINTENANCE

No maintenance required (maintenance free), however conduit employing a caulking bead top seal for the cap should be inspected semi-annually to ensure caulking remains intact. All flashings employing an EPDM Triple Pressure Grommet Seal never need caulking.

## SPECIFICATION (Short Form)

**Rigid Conduit flashing:** Thaler MEF-1 [12" (305 mm)] [18" (457 mm)] high flashing; [.064" (1.6 mm) mill finish 1100-0T alloy aluminum] [.032" (0.831 mm) 24 oz. copper] [.031" (0.79 mm) 22 ga. Type 304 stainless steel]; to CSA B272-93; with EPDM Triple Pressure Grommet Seal for conduit 1/2" (13 mm) and larger, and caulking (by others) for conduit 3/8" (10 mm) dia. and smaller; EPDM Base Seal; [PVC coated deck flange][bituminous painted deck flange]; manufactured by Thaler Metal Industries, 1-800-387-7217 (Mississauga, Ontario, Canada) or 1-800-576-1200 (Buffalo, NY), installed as per manufacturer's written instructions. Provide 20 year warranty against leaks, condensation and defects in materials and/or manufacture.

Continued on reverse...

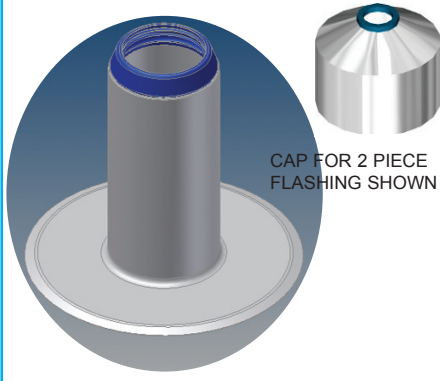
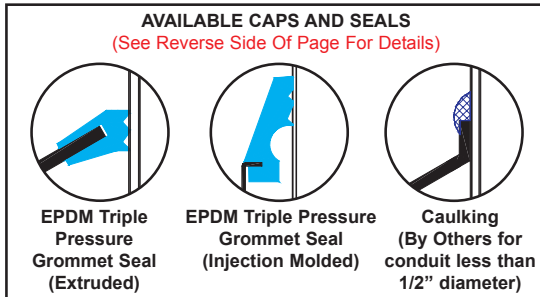

EPDM TRIPLE PRESSURE GROMMET SEAL

When ordering, add -12, or -18 to the end of model number to specify a 12" or 18" high flashing (e.g. MEF-1-A-12)

THALER MEF-1 RIGID CONDUIT FLASHING. AVAILABLE IN ALUMINUM, COPPER OR STAINLESS STEEL

CONVENTIONAL ROOFING ILLUSTRATED

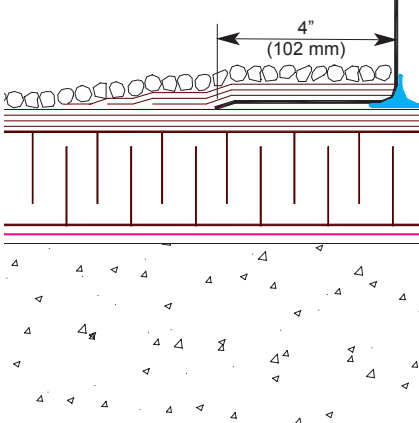

CONCRETE DECK

AVAILABLE TO SUIT RIGID CONDUIT FROM .84" (21 mm) TO 6.625" (168 mm)

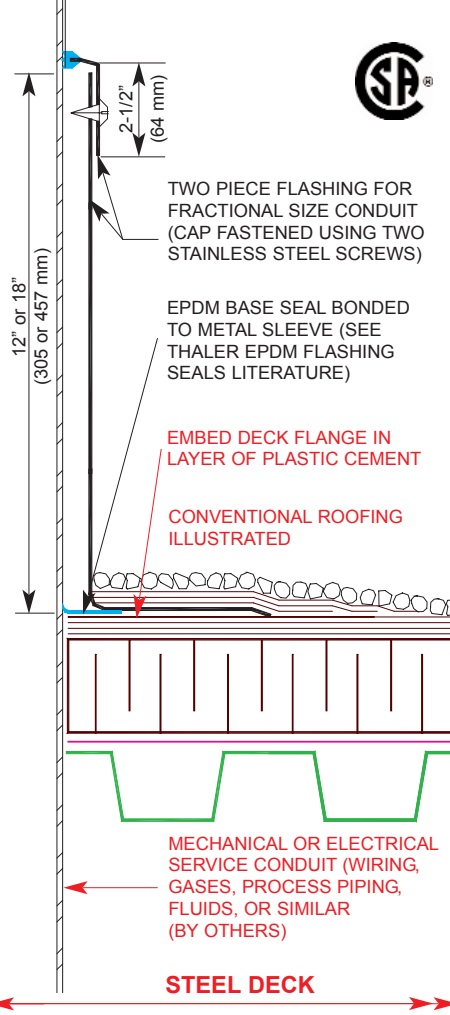

STEEL DECK

## MEF-1 RIGID CONDUIT FLASHING

Patented

## INSTALLATION

"Installation Instructions" are provided with every Thaler product. Essentially, Thaler MEF-1 Flashing is installed by placing the flashing over the conduit or alternatively feeding the conduit through after the flashing has been placed. In either case, install flashing as follows:

**BUR:** Set deck flange in layer of plastic cement and flash in with 3 overlapping layers of felt flashing.

**ModBit:** Torch membrane until bitumen is fluid and set flange into fluid. Flash in flange with two overlapping layers of ModBit and seal with asphalt sealer. Do not overheat (melt) EPDM Base Seal.

**Single Ply:** Set deck flange in layer of membrane adhesive and extend single ply up sleeve to highest elevation possible and clamp membrane to MEF-1 Flashing. Note: for PVC membrane, specify PVC coated flashing by adding suffix P to end of model number, e.g. MEF-1-A-P; weld roofing to deck flange using PVC torch.

**Precautions:** Apply an asphaltic or other type protective coating to aluminum MEF-1 Flashing to a height of 2" (51 mm) above a limestone ballast to avoid corrosive reaction. Also, if coating deck flange with bituminous paint on site, allow 24 hours for drying before applying roof membrane.

**Ordering and Availability:** Specify material required by adding appropriate suffix to model number e.g. MEF-1-A, for aluminum, etc.. Available throughout North America. Contact Thaler for list of distributors and current cost information. Most products are readily available from stock.

## Sizes Chart

This chart illustrates the different EPDM Grommet Seals and Base Seals which will be used for each size conduit, vent pipe, etc.

Trade Size	Actual Size (inches)	Actual Size (millimeters)	Grommet Supplied
1/2"	.84"	(21 mm)	B
3/4"	1.05"	(27 mm)	B
1"	1.315"	(33 mm)	B
1-1/4"	1.66"	(42 mm)	B
1-1/2"	1.9"	(48 mm)	A
2"	2.375"	(60 mm)	A
2-1/2"	2.875"	(73 mm)	B
3"	3.5"	(89 mm)	A
3-1/2"	4"	(102 mm)	A
4"	4.5"	(114 mm)	A
5"	5.563"	(141 mm)	A
6"	6.625"	(168 mm)	A

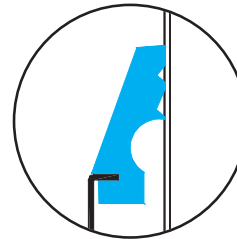

### Type A

EPDM Triple  
Pressure Grommet  
Seal (Injection  
Molded)

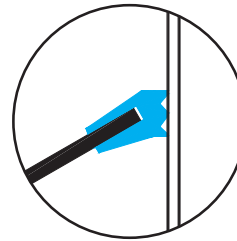

### Type B

EPDM Triple  
Pressure Grommet  
Seal (Extruded)