

## ROOF SPECIALTIES RDX30-A-RR ECONOMY ALUMINUM SUPER-SEAL RETROFIT ROOF DRAIN (All Purpose, Funnel Outlet)

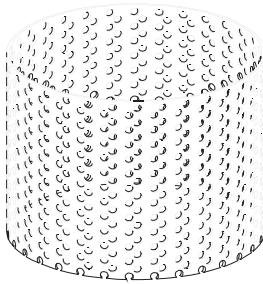

**T-12 STAINLESS  
STEEL BALLAST GUARD**

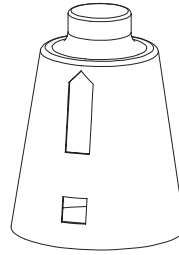

**T-7 ALUMINUM  
FLOW CONTROL ACCESSORY**

**Note:** Specify accessories required by an appropriate suffix to model number e.g. R1 A-T-6 for ferrule, T-7 for flow control, T-10 stainless steel underdeck clamp and T-12 stainless steel ballast guard.

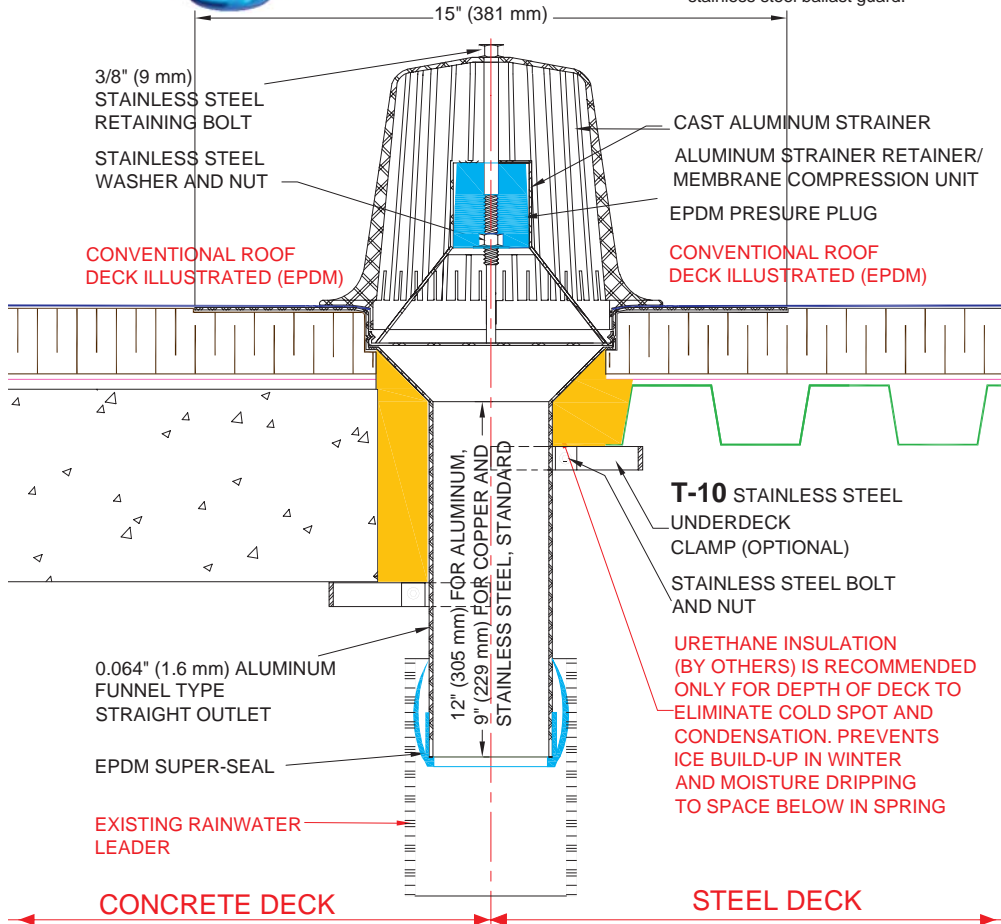

**RDX30-A-RR RETROFIT ROOF DRAIN (Aluminum, Funnel Type Outlet)**  
**RDX30-C-RR RETROFIT ROOF DRAIN (Copper, Funnel Type Outlet)**  
**RDX30-SS-RR RETROFIT ROOF DRAIN (Stainless Steel, Funnel Type Outlet)**  
**Note: RDX30-C-RR (Copper) and RDX30-SS-RR (Stainless Steel) similar. See reverse side of page for material changes.**

### INSTALLATION

"Installation Instructions" are provided with every Thaler product. Essentially, the Thaler RDX30-A-RR roof drain is installed by fitting and connecting the drain outlet into the rainwater leader, slowly pushing down into position, screwing the strainer retainer/membrane compression unit into the funnel, carefully bolting down the strainer to clamp the membrane to the deck flange, and as follows:

**BUR:** Set drain flange over membrane in layer of plastic cement and flash in with 3 overlapping layers of felt flashing.

**ModBit:** Torch membrane until bitumen is fluid and set drain flange into fluid. Flash in flange with two overlapping layers of ModBit and seal with asphalt sealer.

**Single Ply:** Set drain flange in layer of membrane adhesive before applying membrane over flange. Note: for PVC membrane, specify PVC coated drain flange by adding suffix P to end of model number, e.g. RDX30-A-RR-P; weld roofing to drain flange using PVC torch.

**Precautions:** If coating drain flange with a bituminous paint on site, allow 24 hours for drying before applying roof membrane.

**Ordering:** Available throughout North America. Contact Thaler for list of distributors and current cost information. Most products are readily available from stock.

### DESCRIPTION

The Thaler RDX30-A-RR Super-Seal Roof Drain consists of a vandalproof cast aluminum strainer, aluminum strainer retainer/membrane compression unit, deck flange with funnel type straight aluminum outlet fitted with a patented EPDM sealing ring (Thaler Super-Seal). The Super-Seal provides a superior seal in the event drains or pipes become clogged (see Thaler Super-Seal Retrofit Drain Seal literature).

**Prominent Features:** Faster, more economical and easier installation (2 minutes) than competitively positioned drains (no special expertise required). Provides extremely reliable outlet/leader seal. Unique strainer retainer/membrane compression unit also provides best obtainable seal around deck flange by clamping membrane perfectly at a critical juncture (no lateral leakage into roof membrane). Strainer is rendered vandalproof via 3/8" (10 mm) dia. s.s. retaining bolt.

**Leader Diameters:** Suitable for 1-3/4", 2", 2-3/4", 3", 3-3/4", 4", 4-3/4", 5-3/4" and 6" (44 mm, 51 mm, 70 mm, 76 mm, 95 mm, 102 mm, 121 mm, 146 mm and 152 mm) (152 leader sizes).

**Options:** Copper or stainless steel model also available. T-7 aluminum Flow Control accessory (weir) for utilizing roof as temporary reservoir during excessive rainfall. T-10 stainless steel underdeck clamp. T-12 stainless steel ballast guard for inverted roof applications. PVC coated deck flange for PVC roof membrane. Bituminous painted deck flange for BUR and ModBit roof membrane.

### RECOMMENDED USE

Primarily all purpose retrofit economy drain for flat roofs employing conventional roof membrane applications (without ballast guard) or inverted roof membrane applications (with ballast guard). Suitable for PVC, cast iron, steel, copper, or other type leaders.

### APPROVALS

Conforms to ANSI A112.21.2 Roof Drains standard.

### WARRANTY

20 year warranty against defects in materials and/or manufacture when installed in accordance with Thaler "Installation Instructions". Copy of Warranty Certificate available upon request.

### MAINTENANCE

No maintenance required (maintenance free), however, as per CRCA/NRCA recommendations, drains should be inspected twice a year (spring and fall) and any debris removed from both around and inside the strainer.

### SPECIFICATION (Short Form)

**Roof drains:** Thaler RDX30-A-RR drain for [1-3/4" (44 mm)] to [6" (152 mm)] leader size, with: vandalproof cast aluminum strainer with integral gravel guard fins and 3/8" (10 mm) s.s. retaining bolt; strainer retainer/membrane compression unit; .064" (2 mm) spun aluminum compression unit; deck flange with funnel type straight outlet fitted with Super-Seal EPDM sealing ring; [T-7 aluminum flow control accessory]; [T-10 stainless steel underdeck clamp]; [T-12 perforated 22 ga. (0.76 mm) s.s. ballast guard]; [PVC coated deck flange] [bituminous painted deck flange]; manufactured by Thaler Metal Industries, 1-800-387-7217 (Mississauga, Ontario, Canada) or 1-800-576-1200 (New Braunfels, TX), installed as per manufacturer's written instructions. Provide standard 20 year warranty against defects in materials and/or manufacture.

**RDX30-SS-RR**  
**Stainless Steel Roof Drain**  
**Showing Aluminum strainer**  
**Retainer/ Compression Unit**  
**Screwed to Drain Body**

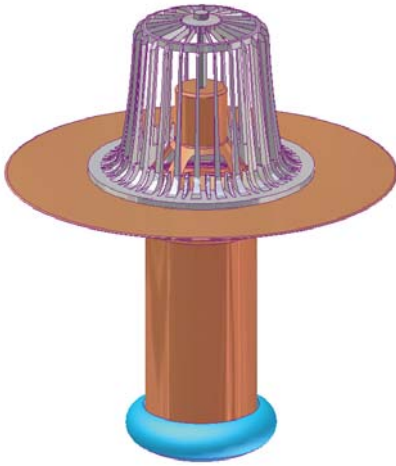

**RDX30-C-RR Copper**  
**Roof Drain**

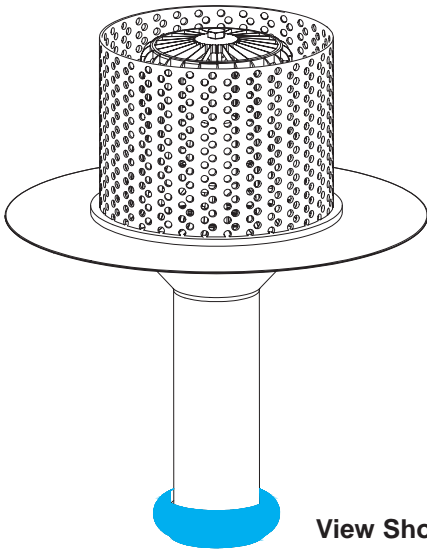

**View Showing T-12**  
**Ballast Guard**  
**Friction Fitted to**  
**Dome Strainer**

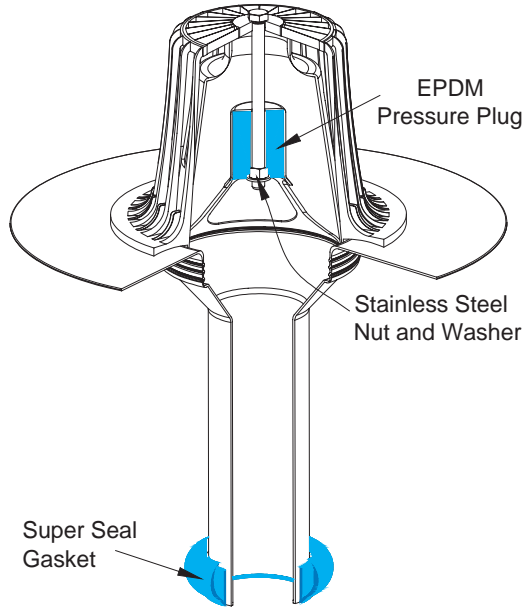

**Cut-Away View Showing**  
**Aluminum**  
**Strainer Retainer/Membrane**  
**Compression Unit**

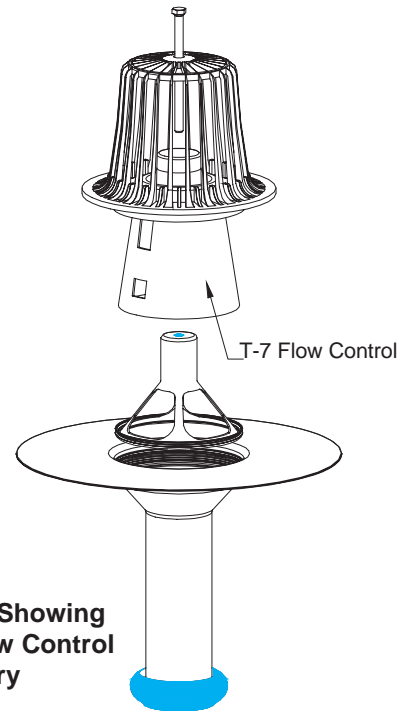

**Exploded View Showing**  
**Optional T-7 Flow Control**  
**Accessory**

**Material Specification for RDX30-C-RR (Copper) and RDX30-SS-RR (Stainless Steel) Roof Drains**  
**(RDX30-A-RR Aluminum Illustrated on page M-24)**

**Note: In Short Form specification on front side of sheet, edit clause to reflect choice of copper**  
**(RDX30-C-RR) or stainless steel (RDX30-SS-RR) roof drain in lieu of aluminum if desired.**

Drain Type	Strainer	Underdeck Clamp	Drain Body and Base	Membrane Compression Unit	T-6 Ferrule	T-7 Flow Control	T-12 Ballast Guard
RDX30-A-RR	Cast Aluminum	Stainless Steel	Aluminum 0.064" (1.6 mm)	Aluminum	Aluminum	Aluminum	Stainless Steel
RDX30-C-RR	Cast Aluminum	Stainless Steel	Copper base: 24 oz. 0.032" (0.831 mm) pipe: DWV 0.058" (1.47mm)	Copper	Brass	Copper or Painted Aluminum	Stainless Steel
RDX30-SS-RR	Cast Aluminum	Stainless Steel	Stainless Steel base: 22 Ga. (0.8mm) pipe: Type 304 L 0.12" (3mm)	Stainless Steel	Stainless Steel	Painted Aluminum or Stainless Steel	Stainless Steel