

ROOF SPECIALTIES

FARA-5NS/-15NS/-15UNS EPDM ROOF "FIXED EYE" FALL ARREST ROOF ANCHORS (Non-Standard Height, For Tapered Insulation, Cast-In- Place)

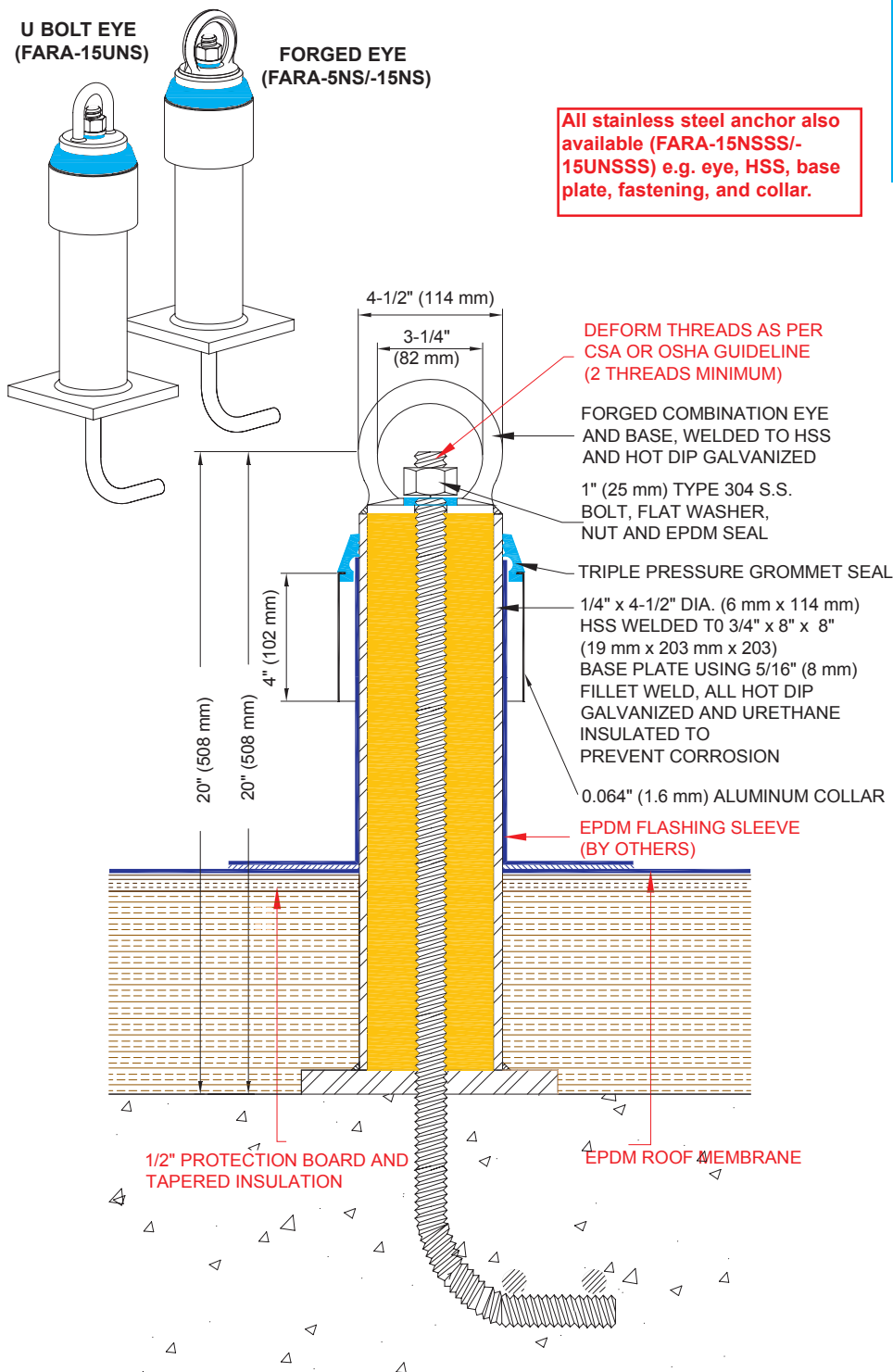

FARA-5NS/-15NS/15UNS EPDM ROOF "FIXED EYE" FALL ARREST ROOF ANCHORS (Non-Standard Height, For Tapered Insulation, Cast-In-Place)

PATENTED

INSTALLATION

"Installation Instructions" are provided with every Thaler product. Essentially, the Thaler FARA-5NS/-15NS/-15UNS Fall Arrest Roof Anchors are installed by through-bolting the anchor to the structural concrete roof deck as per Thaler layout drawings, using a maximum torque of 125 lbf-ft. (169 Nm), deforming the exposed bolt threads, then placing the counterflashing sleeve over the anchor, roof membrane, and EPDM flashing, and as follows:

EPDM: Set flashing deck flange in layer of membrane adhesive and extend single ply up sleeve to highest elevation possible as per membrane manufacturer's recommendations.

Ordering: Available throughout North America. Contact Thaler for list of distributors and current cost information. Most products are readily available from stock. **Note:** The FARA-15NS stainless steel forged eye has a galvanized finish over top of the stainless steel. The process of galvanizing the lower part of the anchor requires the entire anchor to be dipped in the zinc bath, thereby covering the stainless steel eye. If there is any question about product received on site, the eye material may be checked with a magnet. Type 304 stainless steel is non-magnetic.

DESCRIPTION

Thaler FARA Non-Standard height cast-in-place anchors consist of a urethane insulated hollow steel post (HSS) with base plate, single stainless steel bolt for securing to structural concrete roof slab, and flashing sleeve. The top of the anchor is available with three different options:

1. With very high strength, galvanized forged eye (FARA-5NS). All stainless steel (FARA-15NSSS).
2. With very high strength stainless steel forged eye (FARA-15NS). All stainless steel (FARA-15NSSS).
3. With high strength stainless steel U Bolt (FARA-15UNS). All stainless steel (FARA-15UNSSS).

Prominent Features: Extra long to accommodate tapered roof insulation. Condensation free and maintenance free (attractive, neat flashing never needs caulking; see Thaler EPDM Flashing Seals literature). Anchor integrity is backed by \$7,000,000.00 liability insurance.

Options: All stainless steel anchor. PVC coated flashing deck flange for PVC roof membrane. Bituminous painted flashing deck flange for BUR and ModBit roof membrane. See other Thaler FARA models for different securements.

RECOMMENDED USE

Suitable for all flat roofs employing EPDM membrane and tapered insulation (for roof drainage slopes) as fall arrest anchors for securing workers' lifelines or the tying back of suspended access equipment such as outrigger beams and parapet wall clamps. Also suitable for suspension of boatswain chair.

APPLICABLE STANDARDS

Thaler FARA anchors conform to all Canadian and U.S. standards, provincial and state labour/safety codes and materials standards relating to anchor fabrication, window cleaning and other suspended maintenance operations. Conformance includes CSA, OML, ASME, ANSI, IWCA, OSHA, CAL, OSHA, AISC, AWS, and other references.

WARRANTY

20 year warranty (lifetime on stainless steel) against **leaks, condensation and defects** in materials and/or manufacture when installed in accordance with Thaler "Installation Instructions". Copy of Warranty Certificate available upon request.

MAINTENANCE

Regulatory authorities require anchors to be inspected annually with inspection data (date, inspector's name and comments) recorded in the Fall Protection Maintenance Log Book for Window Cleaning and/or Other Suspended Access Maintenance Operations (including travel restraint). Apart from this requirement, Thaler anchors require no maintenance (maintenance free).

PLANNING SERVICE

Thaler will provide layout drawings for fall arrest roof anchors in compliance with all applicable standards, safety regulations and local building codes. A nominal, low-cost fee is charged for this service (refunded if Thaler secures the contract to supply the anchors).

SPECIFICATION (Short Form)

Fall arrest roof anchors: Thaler [FARA-5NS with galvanized forged 1018 steel eye] [FARA-15NS with Type 304 stainless steel forged eye] [FARA-15UNS with Type 304 stainless steel U bolt] roof anchor to [CSA Z91-02] [OSHA 1910.66, Sub parts D and F] with: urethane insulated, hollow, hot dipped galvanized ASTM 500C steel post (HSS) 1/4" (6 mm) wall thickness x 4-1/2" (114 mm) dia. x 18" (457 mm) high welded to 3/4" x 8" x 8" (19 mm x 203 mm x 203 mm) 44W base plate; single 1" (25 mm) Type 304 s.s. bolt with EPDM weather seal, top nut and washer; manufacturer's standard counterflashing of .064" (1.6 mm) mill finish 1100-OT alloy aluminum with EPDM Triple Pressure Grommet Seal; manufactured by Thaler Metal Industries, 1-800-387-7217 (Mississauga, Ontario, Canada) or 1-800-576-1200 (New Braunfels, TX), installed as per manufacturer's written instructions. Provide 20 year warranty against defects in materials and/or manufacture.