

ROOF SPECIALTIES

**FARA-175 SERIES
PORTABLE OUTRIGGER
BEAMS**

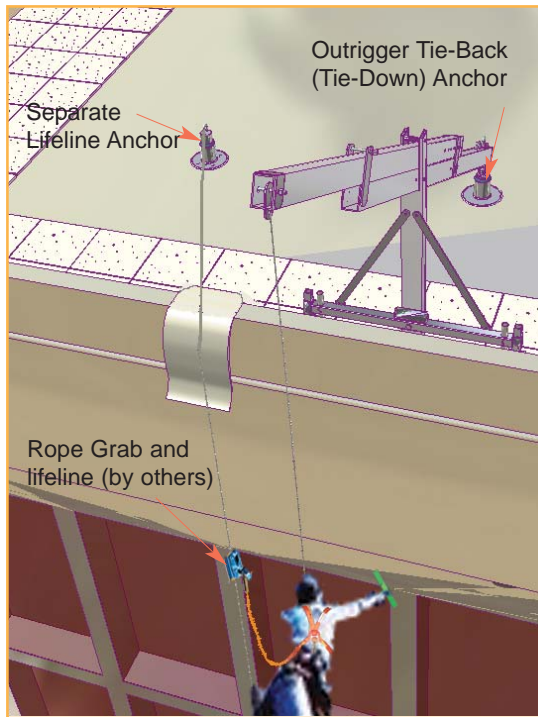

FRONT VIEW

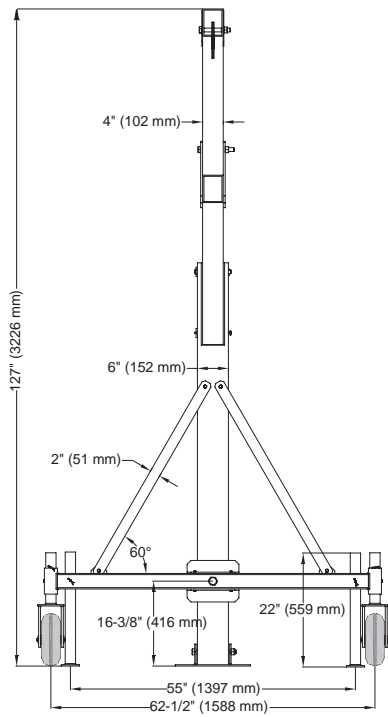
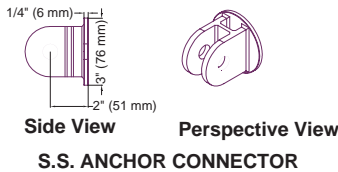

S.S. ANCHOR CONNECTOR

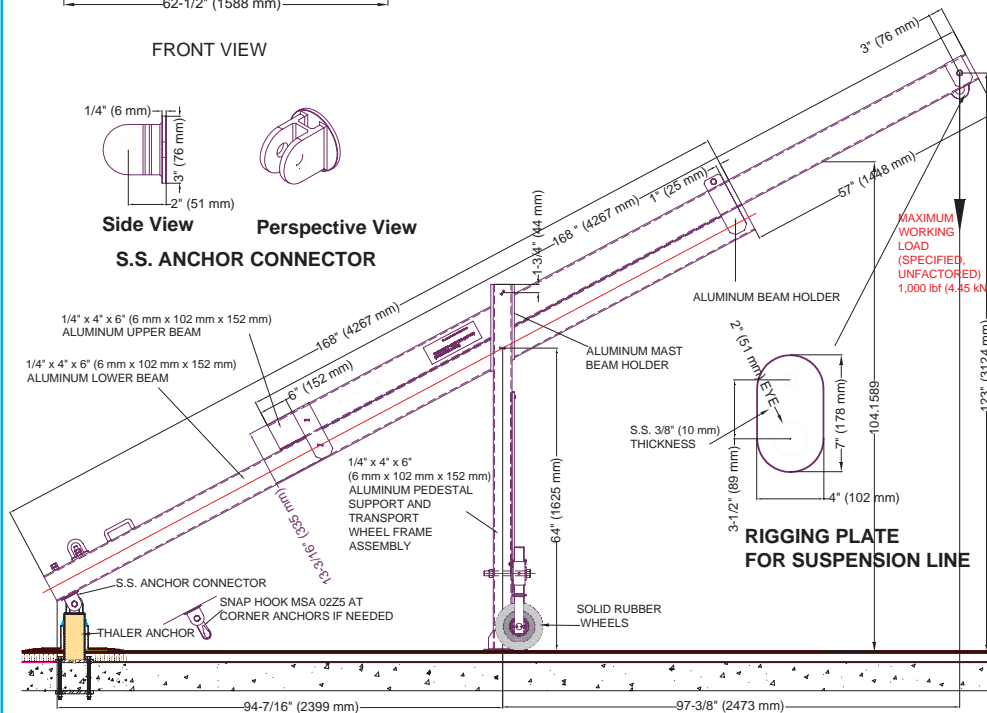

FARA-175-A PORTABLE OUTRIGGER BEAM

INSTALLATION

"Installation Instructions" are provided with every Thaler product. Essentially, the Thaler FARA-Series portable outrigger beam is installed by placing and bolting beams into position on the pedestal frame support, and pinning the tail of the beam to the tie-back (tie down) anchor. The STACK JACK flashing for the roof anchors is installed as follows:

BUR: Set flashing deck flange in layer of plastic cement and flash in with 3 overlapping layers of felt flashing.

ModBit: Torch membrane until bitumen is fluid and set flashing deck flange into fluid. Flash in flange with two overlapping layers of ModBit and seal with asphalt sealer. Do not overheat (melt) EPDM Base Seal.

Single Ply: Set flashing deck flange in layer of membrane adhesive and extend single ply up sleeve to highest elevation possible and clamp membrane to STACK JACK Flashing. Note: for PVC membrane, specify PVC coated STACK JACK by adding suffix P to end of model number, e.g. FARA-170-A-P; weld roofing to deck flange using PVC torch.

Precautions: Apply an asphaltic or other type protective coating to aluminum STACK JACK Flashing to a height of 2" (51 mm) above a limestone ballast to avoid corrosive reaction. Also, if coating deck flange with bituminous paint on site, allow 24 hours for drying before applying roof membrane.

Ordering: Specify flashing material required by adding the appropriate suffix to model number e.g. FARA-175-A-A, for aluminum, etc. Available throughout North America. Contact Thaler for list of distributors and current cost information. Most products are readily available from stock.

DESCRIPTION

The Thaler FARA-175 Series Portable Outrigger Beam consists of an aluminum hollow section extendable upper and lower beam, aluminum vertical support leg and beam holder to receive the beams, and transport wheel assembly. Outrigger beams require Thaler tie-back (tie down) anchors and separate worker lifeline anchors with Thaler STACK JACK flashing.

Prominent Features: Urethane insulated anchors prevent formation of condensation (corrosion protection). Maintenance free (attractive, neat flashing never needs caulking; see Thaler EPDM Flashing Seals literature). Structural integrity is backed by high \$7,000,000.00 liability insurance.

Options: Range of models to suit various parapet heights. Range of lifeline anchors for all roof types. PVC coated flashing deck flange for PVC roof membrane. Bituminous painted deck flange for BUR and ModBit roof membrane.

RECOMMENDED USE

Suitable for all low slope/flat roofs for suspending a platform or single point access equipment such as baskets (cages) and manually or power operated boatswain chairs, for window cleaning or other exterior building maintenance.

APPLICABLE STANDARDS

Thaler FARA Outriggers and Fall Arrest Roof Anchors conform to all Canadian and U.S. standards, provincial and state labour/safety codes and materials standards relating to anchor fabrication, window cleaning and other suspended maintenance operations. Conformance includes CSA, OML, ASME, ANSI, IWCA, OSHA, CAL OSHA, AISC, AWS, and other references. Thaler SJ-34(7) and SJ-35(13) New-Standard STACK JACK Flashing conforms to CSA B272-93.

WARRANTY

20 year warranty against leaks, condensation and defects in materials and/or manufacture when installed in accordance with Thaler "Installation Instructions". Copy of Warranty Certificate available upon request. Note: leaks and condensation refer to tie-back and lifeline anchors

MAINTENANCE

Regulatory authorities require outriggers and anchors to be inspected annually with inspection data (date, inspector's name and comments) recorded in the Fall Protection Maintenance Log Book for Window Cleaning and/or Other Suspended Access Maintenance Operations (including travel restraint). Apart from this requirement, Thaler outriggers beams require no maintenance (maintenance free).

PLANNING SERVICE

Without obligation, Thaler will provide layout drawings for outriggers and fall arrest anchors in compliance with all applicable standards, safety regulations and local building codes.

SPECIFICATION (Short Form)

Portable Outrigger beams: Thaler [FARA-175-A] [FARA-175-B] [FARA-175-C] [FARA-175-D] Portable Outrigger Beam to [CSA Z91-02] [OSHA 1910.66, Sub parts D and F] with 1/4" x 4" x 6" (6 mm x 102 mm x 152 mm) T-6061 aluminum upper and lower sliding beam; 1/4" x 4" x 6" (6 mm x 102 mm x 152 mm); pedestal to receive adjustable beam; 3/8" (10 mm) s.s. eye suspension line attachment rigging plate; aluminum T-6061 transport wheel frame; stainless steel anchor connectors; [galvanized] [stainless steel] urethane insulated tie-back (tie down) anchor and separate lifeline anchor both with [SJ-34, 7" (178 mm) high] [SJ-35, 13" (330 mm) high] New-Standard STACK JACK flashing of [.064" (1.6 mm) mill finish 1100-07 alloy aluminum] [.021" (0.53 mm) 16 oz. copper] [.018" (0.46 mm) Type 304 stainless steel] to CSA B272-93, with EPDM Triple Pressure Grommet Top Seal and EPDM Base Seal and [PVC coated deck flange] [bituminous painted deck flange]; manufactured by Thaler Metal Industries, 1-800-387-7217 (Mississauga, Ontario, Canada) or 1-800-576-1200 (Niagara Falls, NY), installed as per manufacturer's written instructions. Provide 20 year warranty against leaks, condensation and defects in materials and/or manufacture.

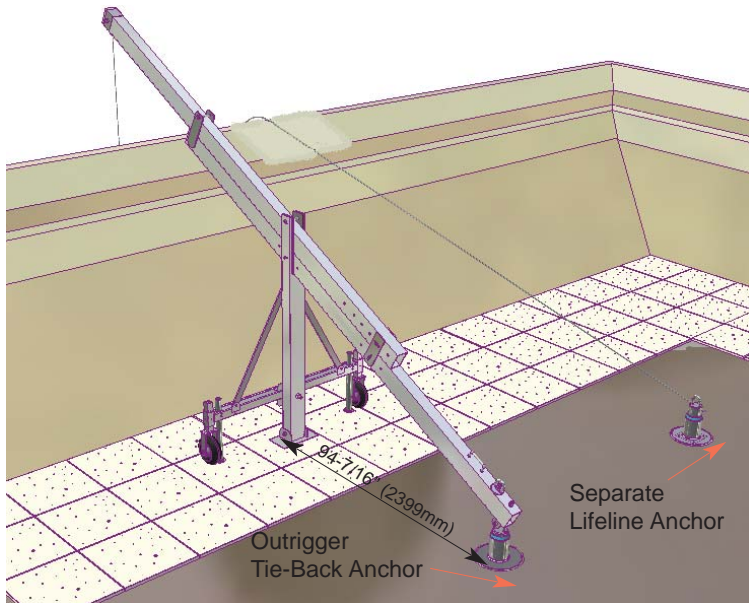

FARA-175-A PORTABLE OUTRIGGER BEAM
For Parapets up to 96'-3/4" (2667 mm) High

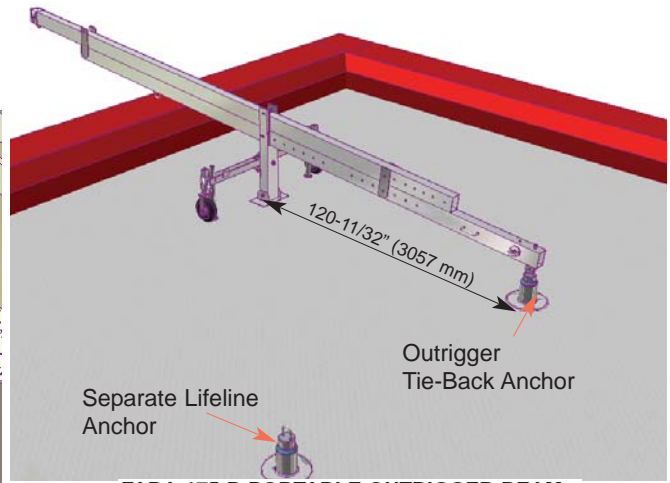

FARA-175-B PORTABLE OUTRIGGER BEAM
For Parapets up to 35" (889 mm) High



FARA-175-C PORTABLE OUTRIGGER BEAM
For Parapets up to 60" (1524 mm) High

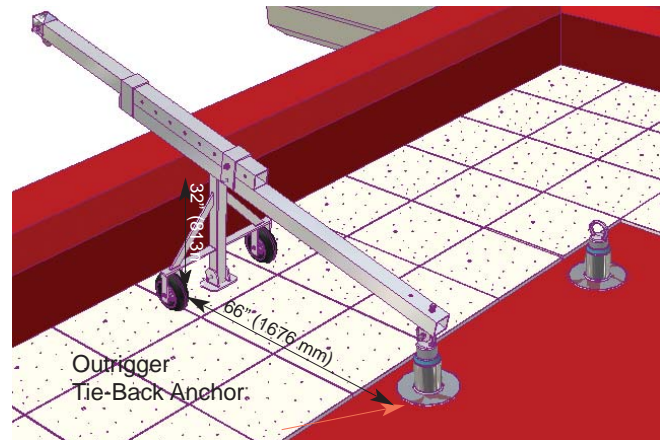

FARA-175-D PORTABLE OUTRIGGER BEAM
For Parapets up to 40" (1016 mm) High

Note: All Anchors are designed to resist without fracture a pull-out force of 5400 lbs (24.02 kN), applied in the most adverse direction

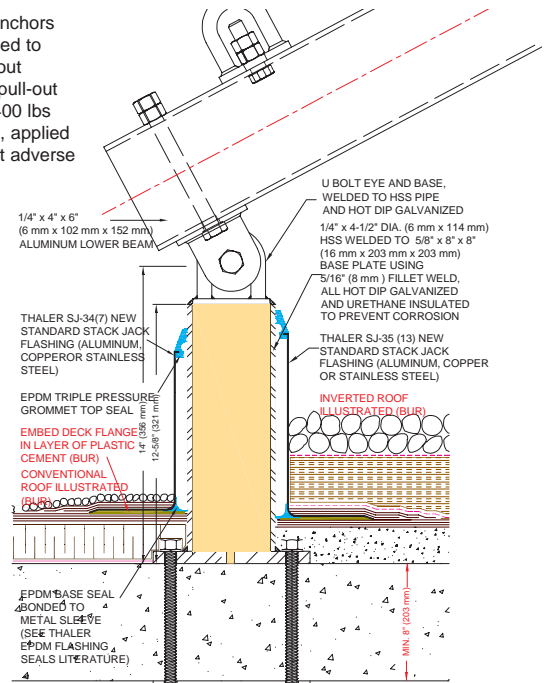

SECTION THROUGH TIE-BACK ANCHOR
(Bolt Through Fastening Shown. See Alternative Fastenings Below)

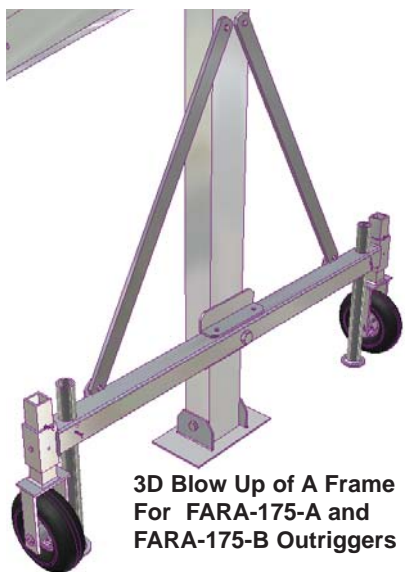
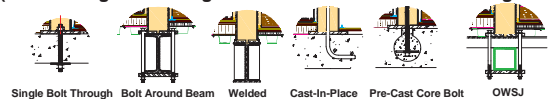

3D Blow Up of A Frame
For FARA-175-A and
FARA-175-B Outriggers

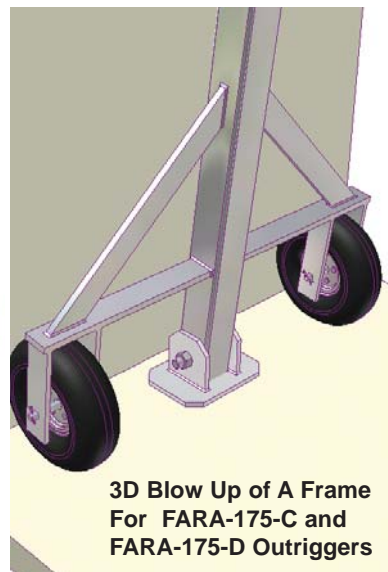

3D Blow Up of A Frame
For FARA-175-C and
FARA-175-D Outriggers