

## ROOF SPECIALTIES FARA-85/-95/-95U FALL ARREST WALL ANCHORS (Pier Bolt)

Anchor Type	Eye Construction	Load Direction	Deflection After Load of 5400 lbs (24.03 kN) was Released
FARA-85	Forged Eye, Galvanized	Perpendicular to the eye (x)	0.016" (0.406 mm)
FARA-95	Forged Eye, Stainless Steel	Perpendicular to the eye (x)	0.065" (1.651 mm)
FARA-95U	U Bolt, Stainless Steel	Perpendicular to the eye (x)	0.456" (11.582 mm)

**FORGET EYE  
(FARA-85/-95)**

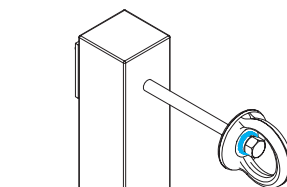

**U BOLT EYE  
(FARA-95U)**

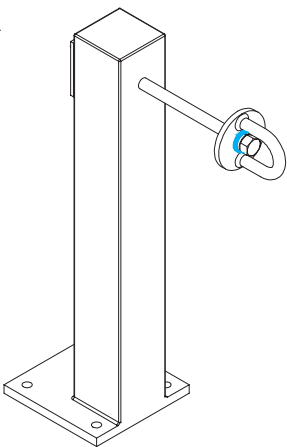

Note: Anchors are designed to resist without fracture and/or pull-out a force of 5400 lbs (24.03 kN), applied in the most adverse direction (x). All testing reports available upon request.

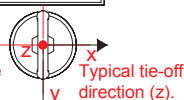

DEFORM THREADS AS PER CSA OR OSHA GUIDELINE

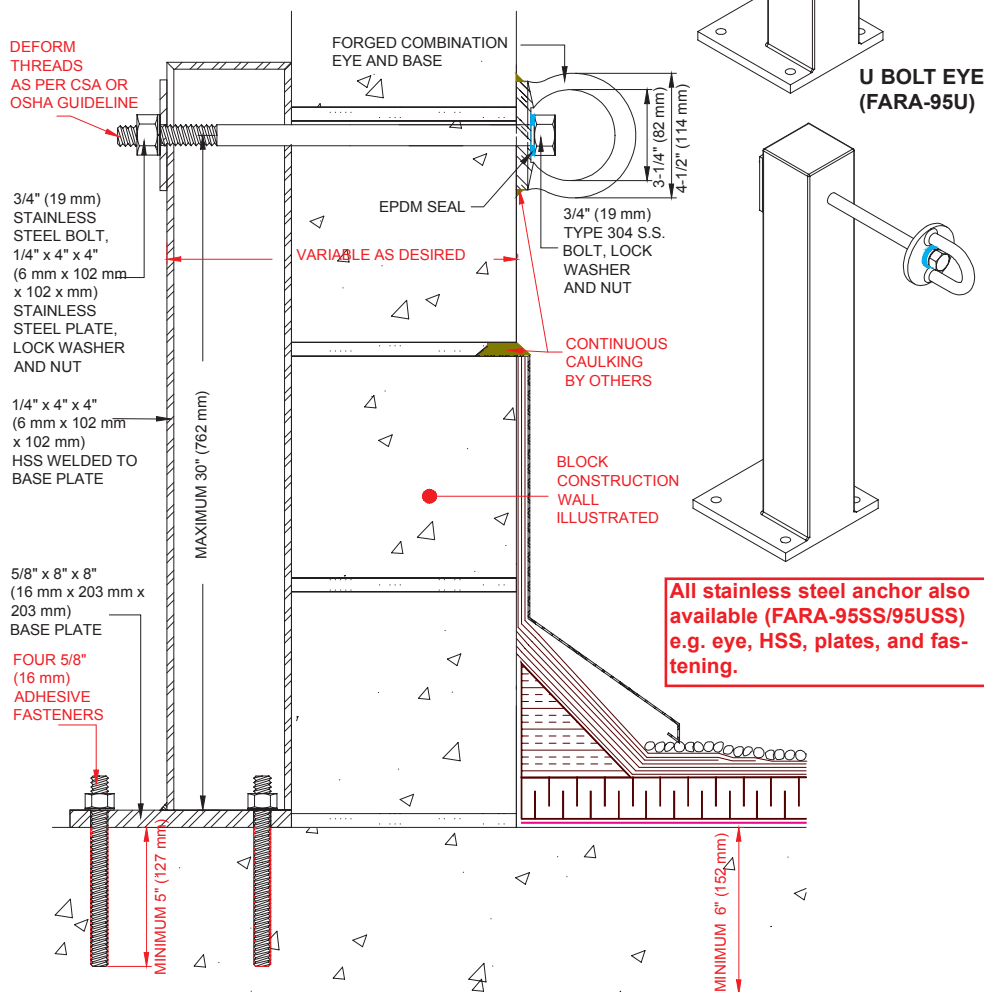

All stainless steel anchor also available (FARA-95SS/95USS) e.g. eye, HSS, plates, and fastening.

### FARA-85/-95/-95U FALL ARREST WALL ANCHORS (Pier Bolt)

PATENTED

NOTE: REFER TO PAGES I-34, I-35, I-36 FOR NON-STANDARD HEIGHT ANCHORS

#### INSTALLATION

"Installation Instructions" are provided with every Thaler product. Essentially, Thaler FARA-85/-95/-95U wall anchor is installed by drilling a hole in the non structural wall, installing the anchor (using a maximum torque of 100 lbf-ft (135 Nm), in a structurally adequate concrete floor or roof slab, deforming the exposed threads of the pier anchor bolt, and applying a caulking bead (by others) around the eye wall plate. Adhesive bolts to be installed as per bolt manufacturer's instructions.

**Ordering:** Available throughout North America. Contact Thaler for a list of distributors and current cost information. Most products are readily available from stock.

#### DESCRIPTION

Thaler FARA pier bolt anchors consist of an anchor eye and single steel bolt secured to a floor mounted steel pier located behind a non-structural wall. The anchor eye is available with three different options:

1. With very high strength, *galvanized forged eye* (FARA-85). All stainless steel (FARA-95SS).
2. With very high strength *stainless steel forged eye* (FARA-95). All stainless steel (FARA-95SS).
3. With high strength *stainless steel U Bolt* (FARA-95U). All stainless steel (FARA-95USS).

**Prominent Features:** Anchor integrity is backed by \$7,000,000.00 liability insurance.

**Options:** All stainless steel anchor, or see other Thaler FARA models for different securements.

#### RECOMMENDED USE

For any type non-structural wall (mechanical room, penthouse, elevator room, etc.) as fall arrest anchors for securing workers' lifelines or the tying back of suspended access equipment such as outrigger beams and parapet wall clamps. Also suitable for suspension of boatswain chair. Ideal for retrofit.

#### APPLICABLE STANDARDS

Thaler FARA anchors conform to all Canadian and U.S. standards, provincial and state labour/safety codes and materials standards relating to anchor fabrication, window cleaning and other suspended maintenance operations. Conformance includes CSA, OMLASME, ANSI, IWCA, OSHA, CAL, OSHA, AISC, AWS, and other references.

#### WARRANTY

20 year warranty (lifetime on all stainless steel) against defects in materials and/or manufacture when installed in accordance with Thaler "Installation Instructions". Copy of Warranty Certificate available upon request.

#### MAINTENANCE

Regulatory authorities require anchors to be inspected annually with inspection data (date, inspector's name and comments) recorded in the Fall Protection Maintenance Log Book for Window Cleaning and/or Other Suspended Access Maintenance Operations (including travel restraint). Also, the caulking bead around the eye base plate should be inspected periodically and maintained if necessary.

#### PLANNING SERVICE

Thaler will provide layout drawings for fall arrest anchors in compliance with all applicable standards, safety regulations and local building codes. A nominal, low-cost fee is charged for this service (refunded if Thaler secures the contract to supply the anchors).

#### SPECIFICATION (Short Form)

**Fall arrest wall anchors:** Thaler [FARA-85 with galvanized forged 1018 steel eye] [FARA-95 with Type 304 stainless steel forged eye] [FARA-95U with Type 304 stainless steel U bolt] wall anchor to [CSA Z91-02] [OSHA 1910.66, Sub parts D and F] with single 3/4" (19 mm) dia. s.s. pier bolt and s.s. 1/4" x 4" (6 mm x 102 mm x 102 mm) s.s. backup plate; 1/4" x 4" x 4" (6 mm x 102 mm x 102 mm) epoxy primed ASTM 500C HSS pier welded to a 5/8" x 8" x 8" (16 mm x 203 mm x 203 mm) epoxy primed 44W base plate prepared to receive four 5/8" (16 mm) anchor bolts (by others); manufactured by Thaler Metal Industries 1-800-387-721 (Mississauga, Ontario, Canada) or 1-800-576-1200 (New Braunfels, TX), installed as per manufacturer's written instructions. Provide 20 year warranty against leaks, condensation and defects in materials and/or manufacture.