

ROOF SPECIALTIES FARA-84/-94/-94U FALL ARREST WALL ANCHORS (Cladding-Bolt)

DESCRIPTION

Thaler FARA cladding-bolt anchors consist of an anchor eye welded to an HSS cladding spacer, and a single stainless steel bolt with a backup plate. The anchor eye is available with three different options:

1. With very high strength, *galvanized forged eye* (FARA-84). All stainless steel (FARA-94SS).
2. With very high strength *stainless steel forged eye* (FARA-94). All stainless steel (FARA-94SS).
3. With high strength *stainless steel U Bolt* (FARA-94U). All stainless steel (FARA-94USS).

Prominent Features: Condensation free. Anchor integrity is backed by \$7,000,000.00 liability insurance.

Options: See other Thaler FARA models for different securements.

RECOMMENDED USE

For structurally adequate concrete walls with a cladding finish (metal siding, brick, etc.) as fall arrest anchors for securing workers' lifelines or the tying back of suspended access equipment such as outrigger beams and parapet wall clamps. Also suitable for suspension of boatswain chair.

APPLICABLE STANDARDS

Thaler FARA anchors conform to all Canadian and U.S. standards, provincial and state labour/safety codes and material standards relating to anchor fabrication, window cleaning and other suspended maintenance operations. Conformance includes CSA, OML, ASME, ANSI, IWCA, OSHA, CAL, OSHA, AISC, AWS, and other references.

WARRANTY

20 year warranty against defects in materials and/or manufacture when installed in accordance with Thaler "Installation Instruction. Copy of Warranty Certificate available upon request.

MAINTENANCE

Regulatory authorities require anchors to be inspected annually with inspection data (date, inspector's name and comments) recorded in the Fall Protection Maintenance Log Book for Window Cleaning and/or Other Suspended Access Maintenance Operations (including travel restraint). Also, the caulking bead around the eye base plate should be inspected periodically and maintained if necessary.

PLANNING SERVICE

Thaler will provide layout drawings for fall arrest anchors in compliance with all applicable standards, safety regulations and local building codes. A nominal, low-cost fee is charged for this service (refunded if Thaler secures the contract to supply the anchors).

SPECIFICATION (Short Form)

Fall arrest wall anchors: Thaler [FARA-84 with galvanized forged 1018 steel eye] [FARA-94 with Type 304 stainless steel forged eye] [FARA-94U with Type 304 stainless steel U bolt] wall anchor to [CSA Z91-02] [OSHA 1910.66, Sub parts D and F] with single 3/4" (19 mm) dia. s.s. bolt and EPDM washer seal, ASTM 500C HSS cladding spacer, 1/4" x 4" x 4" (6 mm x 102 mm x 102 mm) s.s. backup plate, lock washer and nut; manufactured by Thaler Metal Industries, 1-800-387-7217 Mississauga, Ontario, Canada) or 1-800-576-1200 (New Braunfels, TX), installed as per manufacturer's written instructions. Provide 20 year warranty against defects in materials and/or manufacture.

FORGED EYE (FARA-84/-94)

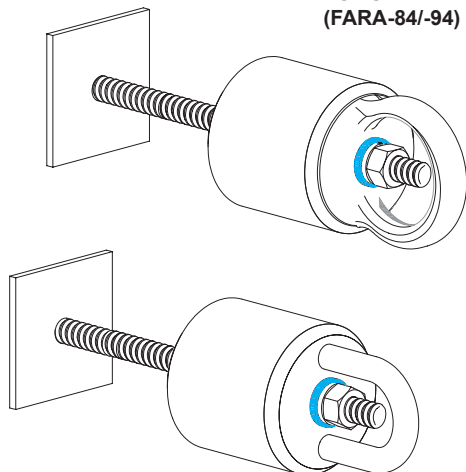

U BOLT EYE (FARA-94U)

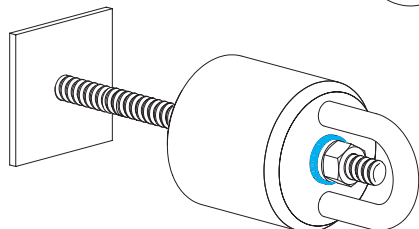

Anchor Type	Eye Construction	Load Direction	Deflection After Load of 5400 lbs (24.03 kN) was Released
FARA-84	Forged Eye, Galvanized	Perpendicular to the eye (x)	0.016" (0.406 mm)
FARA-94	Forged Eye, Stainless Steel	Perpendicular to the eye (x)	0.065" (1.651 mm)
FARA-94U	U Bolt, Stainless Steel	Perpendicular to the eye (x)	0.456" (11.582 mm)

Anchors are designed to resist without fracture and/or pull-out a force of 5400 lbs (24.03 kN), applied in the most adverse direction (x). All testing reports available upon request.

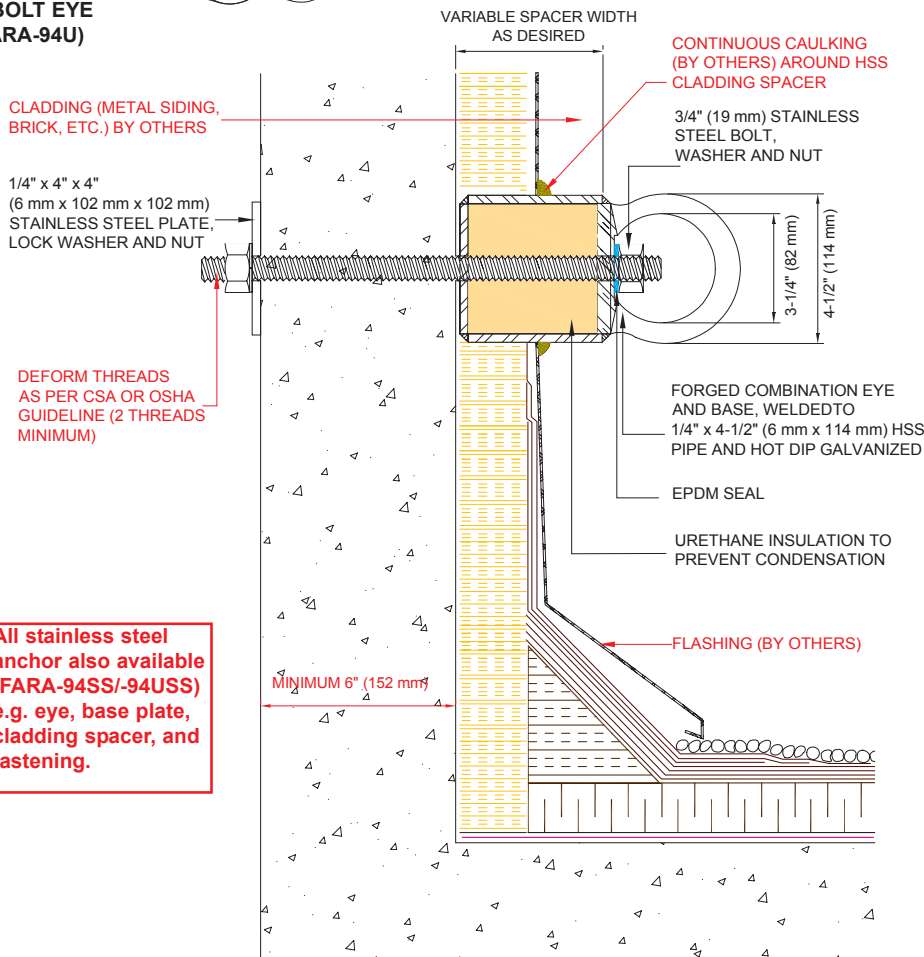
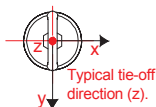

All stainless steel anchor also available (FARA-94SS/-94USS) e.g. eye, base plate, cladding spacer, and fastening.

FARA-84/-94/-94U FALL ARREST WALL ANCHORS (Cladding Bolt)

PATENTED

NOTE: REFER TO PAGES I-34, I-35, I-36 FOR NON-STANDARD HEIGHT ANCHORS

INSTALLATION

"Installation Instructions" are provided with every Thaler product. Essentially, Thaler FARA-84/-94/-94U wall anchors are installed by drilling a hole in the concrete wall, using a maximum torque of 100 lbf.-ft (135 Nm), installing the anchor and applying a caulking bead (supplied by others) around the cladding spacer after the cladding has been installed.

Ordering: Available throughout North America. Contact Thaler for a list of distributors and current cost information. Most products are readily available from stock. **Note:** The FARA-94 stainless steel forged eye has a galvanized finish over top of the stainless steel. The process of galvanizing the the anchor requires the entire anchor to be dipped in the zinc bath, thereby covering the stainless steel eye. If there is any question about product received on site, the eye material may be checked with a magnet. Type 304 stainless steel is non-magnetic.