

## ROOF SPECIALTIES

# MERS-800A DUCT SUPPORT

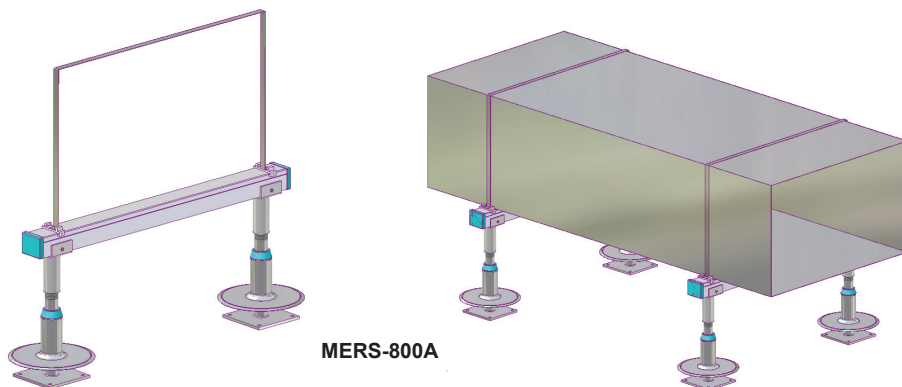

MERS-800A

### DESCRIPTION

Thaler MERS-800A Duct Support consists of a pair of round, urethane insulated, hollow section 6061-T6 aluminum supports with threaded leg assembly for vertical adjustment and mounting plate, mounting hardware (adhesive type supplied by others), and cross-bar carrier with EPDM end caps. Urethane insulated STACK JACK flashings available in aluminum, copper, or stainless steel, with EPDM Triple Pressure Grommet Seal at the top of the flashing and EPDM Base Seal, complete the supports.

**Support Spacing:** To be determined by mechanical engineer for safe loading.

**Prominent Features:** Threaded leg assembly provides up to 4" (102 mm) vertical adjustment. Light weight, strong-as-steel and non corrosive. Maintenance free (EPDM flashing seals never need caulking. See Thaler EPDM Flashing Seals literature).

**Options:** See Section A of manual for STACK JACK Flashing options.

### RECOMMENDED USE

Suitable for all flat roofs as a duct support. Ultimate bearing load is 7350 lbs. (3334 kg) per leg; apply appropriate safety factor.

### WARRANTY

20 year warranty against leaks, condensation and defects in materials and/or manufacture when installed in accordance with Thaler "Installation Instructions". Copy of Warranty Certificate available upon request.

### MAINTENANCE

No maintenance required (maintenance free).

### SPECIFICATION (Short Form)

**Duct supports:** Thaler MERS-800A, adjustable height 6061-T6 hollow aluminum with mill finish, urethane insulated supports, 2" (51 mm) dia., with appropriate hardware (adhesive type supplied by others) for fastening to structural roof deck and cross-bar carrier assembly of length to suit application with EPDM end caps; [SJ-34, non-insulated New-Standard STACK JACK flashing for concrete deck] [SJ-37 pre-insulated New-Standard STACK JACK flashing for steel deck] 7" (178 mm) high consisting of [.064" (1.6 mm) mill finish 1100-OT alloy aluminum] [.032" (0.831 mm) 24 oz. copper] [.031" (0.79 mm) 22 ga. Type 304 stainless steel], 2" (51 mm) dia. to CSA B272-93; with EPDM Triple Pressure Grommet Seal and EPDM Base Seal and [PVC coated deck flange] [bituminous painted deck flange]; manufactured by Thaler Metal Industries, 1-800-387-7217 (Mississauga, Ontario, Canada) or 1-800-576-1200 (New Braunfels, TX), installed as per manufacturer's written instructions. Provide 20 year warranty against leaks, condensation and defects in materials and/or manufacture.

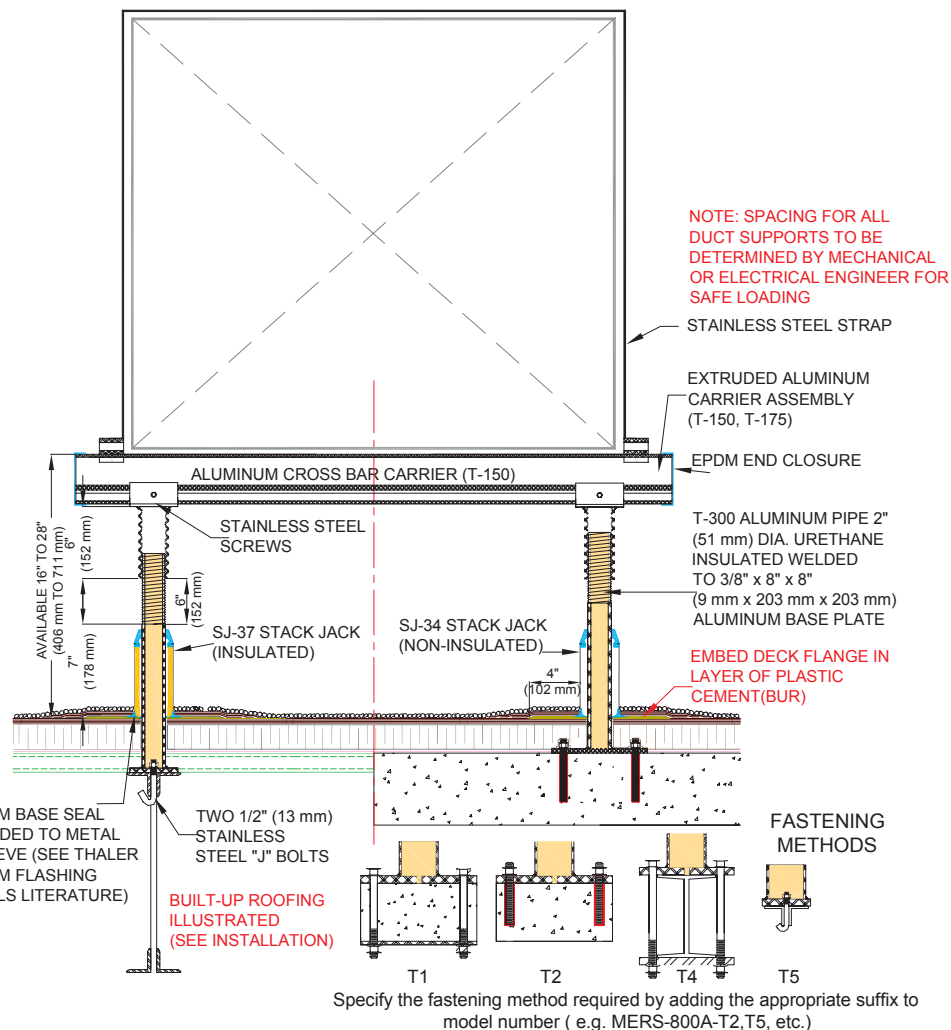

## MERS-800A DUCT SUPPORT

PATENTED

### INSTALLATION

"Installation Instructions" are provided with every Thaler product. Essentially, the Thaler MERS-800A Duct Support is installed at required centres by fastening the aluminum mounting plate to the structural roof deck, placing the flashing sleeve over the support and roof membrane, installing the cross-bar carrier, and as follows:

**BUR:** Set flashing deck flange in layer of plastic cement and flash in with 3 overlapping layers of felt flashing.

**ModBit:** Torch membrane until bitumen is fluid and set flashing deck flange into fluid. Flash in flange with two overlapping layers of ModBit and seal with asphalt sealer. Do not overheat (melt) EPDM Base Seal.

**Single Ply:** Set flashing deck flange in layer of membrane adhesive and extend single ply up sleeve to highest elevation possible and clamp membrane to STACK JACK Flashing. Note: for PVC membrane, specify PVC coated aluminum, etc. STACK JACK by adding suffix P to the end of model number, e.g. MERS-800A-A-P; weld roofing to deck flange using PVC torch.

**Precautions:** Apply an asphaltic or other type protective coating to aluminum STACK JACK Flashing to a height of 2" (51 mm) above a limestone ballast to avoid corrosive reaction. Also, if coating deck flange with bituminous paint on site, allow 24 hours for drying before applying roof membrane.

**Duct Cross-Bar Carrier:** Thread hollow aluminum upper support onto lower support leg, install cross-bar carrier, and place duct (by others) on carrier.

**Ordering and Availability:** Specify flashing material required by adding appropriate suffix to model number e.g. MERS-800A-A, for aluminum, etc. Available throughout North America. Contact Thaler for list of distributors and current cost information. Most products are readily available from stock.

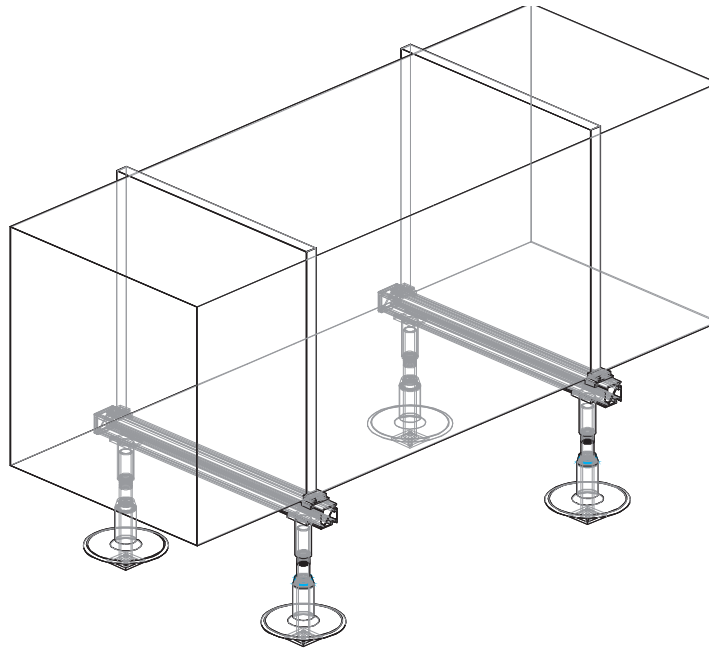

Note: The following table indicates the allowable uniform working loads for aluminum cross bar carrier beam T-150. The beam extends a minimum of 3" (76 mm) beyond the center line of support.

### MERS-800A DUCT SUPPORT

Span	Maximum Uniformly Distributed Load	Total Load
3'-0" (914 mm)	900 plf (13 kN/m)	2700 lbs (12.15 kN)
4'-0" (1219 mm)	675 plf (9.8 kN/m)	2700 lbs (12.15 kN)
5'-0" (1524 mm)	540 plf (7.9 kN/m)	2700 lbs (12.15 kN)
6'-0" (1829 mm)	450 plf (6.6 kN/m)	2700 lbs (12.15 kN)
7'-0" (2133 mm)	330 plf (4.8 kN/m)	2310 lbs (10.39 kN)
8'-0" (2438 mm)	250 plf (3.6 kN/m)	2000 lbs (9kN)
9'-0" (2743 mm)	200 plf (2.9 kN/m)	1800 lbs (8.1 kN)
10'-0" (3048 mm)	160 plf (2.3 kN/m)	1600 lbs (7.2 kN)

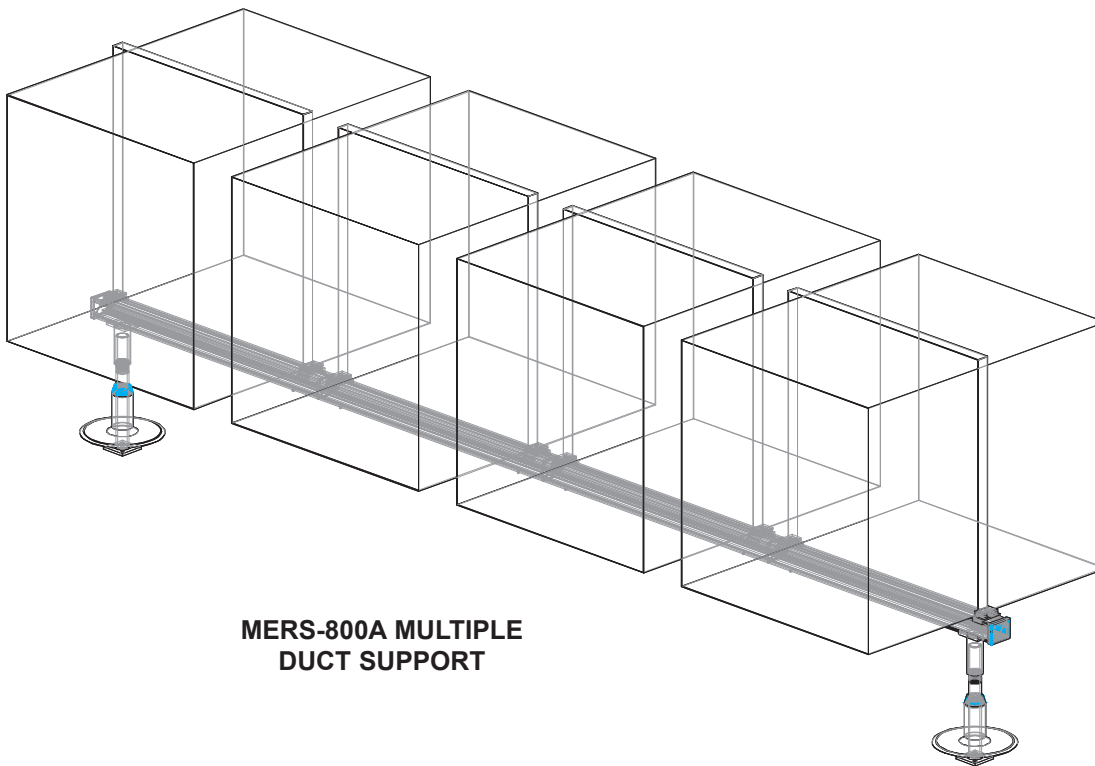

### MERS-800A MULTIPLE DUCT SUPPORT