

ROOF SPECIALTIES ARS-520/520-1/520-2 METAL STAIR ROOF SUPPORTS (Offset Stringer)

MODEL NUMBER	HSS SUPPORT PIPE			THREAD Ø	BASE PLATE		CONNECTOR ANGLE VERTICAL LEG DIMENSIONS	FASTENING BOLT Ø
	Height	Outside Ø	Thickness		Bolt Securement	Weld Securement		
ARS-520	14" (356 mm)	2-3/8" (60 mm)	1/4" (6 mm)	1" (25 mm)	1/4" X 12" X 12" (6 mm x 305 mm x 305 mm)	3/8" X 4" X 4" (10 mm x 102 mm x 102 mm)	1/4" X 4" X 4" (6 mm x 102 mm x 102 mm)	1/4" (6 mm)
ARS-520-1	14" (356 mm)	3-1/2" (89 mm)	1/4" (6 mm)	2" (51 mm)	3/8" X 12" X 12" (10 mm x 305 mm x 305 mm)	1/2" X 6" X 6" (13 mm x 152 mm x 152 mm)	3/8" X 4" X 4" (10 mm x 102 mm x 102 mm)	3/8" (10 mm)
ARS-520-2	14" (356 mm)	4-1/2" (114 mm)	1/4" (6 mm)	2" (51 mm)	5/8" X 12" X 12" (16 mm x 305 mm x 305 mm)	5/8" X 8" X 8" (16 mm x 203 mm x 203 mm)	5/8" X 5" X 5" (16 mm x 127 mm x 127 mm)	5/8" (16 mm)

FOR SUPPORTS OTHER THAN STANDARD 14" (356 mm) HEIGHT, ADD SUFFIX "NS" TO MODEL NUMBER I.E. ARS-520-2NS

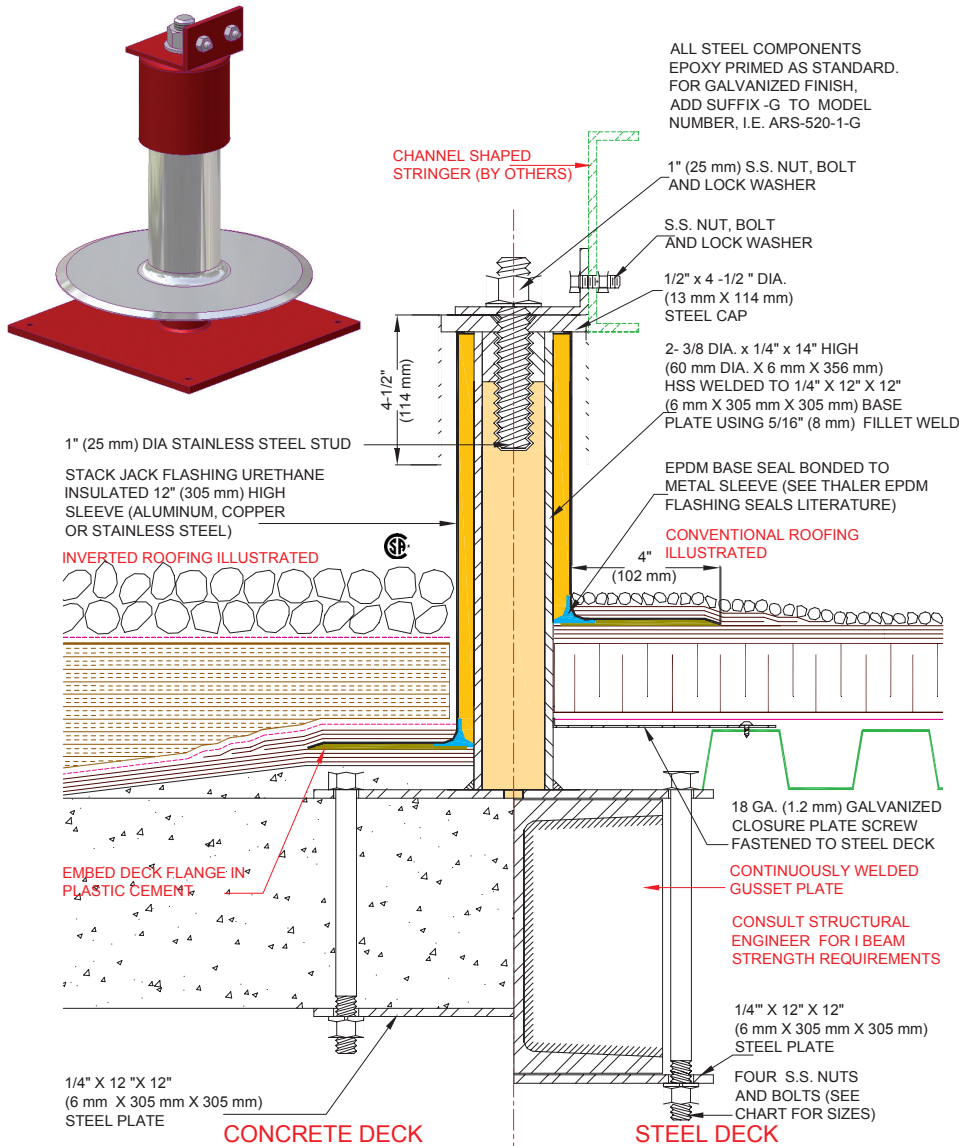

ARS-520, 520-1, 520-2 METAL STAIR ROOF SUPPORT (Offset Stringer)
PATENTED

INSTALLATION

"Installation Instructions" are provided with every Thaler product. Essentially, the Thaler ARS-520 Roof Support is installed by fastening the mounting plate to the structural roof deck, placing the flashing sleeve over the support and roof membrane, installing the steel cap/stringer connector angle, and as follows:

BUR: Set flashing deck flange in layer of plastic cement and flash in with 3 overlapping layers of felt flashing.

ModBit: Torch membrane until bitumen is fluid and set flashing deck flange into fluid. Flash in flange with two overlapping layers of ModBit and seal with asphalt sealer. Do not overheat (melt) EPDM Base Seal.

Single Ply: Set flashing deck flange in layer of membrane adhesive and extend single ply up sleeve to top of metal flashing and then screw cap down over single ply. Note: for PVC membrane, specify PVC coated aluminum, etc. flashing deck flange by adding suffix P to end of model number e.g. ARS-520-A-P; weld roofing to deck flange using PVC torch.

Precautions: Apply an asphaltic or other type protective coating to aluminum flashing to a height of 2" (51 mm) above a limestone ballast to avoid corrosive reaction. Also, if coating deck flange with a bituminous paint on site, allow 24 hours for drying before applying roof membrane.

Stringer Components: Thread upper portion of support (with stringer connector angle) onto lower support leg and mechanically attach stringer (by others), using 3/8" (10 mm) stainless steel bolts provided.

Ordering and Availability: Specify flashing material required by adding appropriate suffix to model number e.g. ARS-520-A, for aluminum, etc. Available throughout North America. Contact Thaler for list of distributors and current cost information. Most products are readily available from stock.

DESCRIPTION

Thaler ARS-520 selection of Metal Stair Roof Supports consist of a urethane insulated, epoxy primed, hollow steel support and mounting plate, flashing, mounting hardware (adhesive fasteners supplied by others) adjustable height steel cap and stainless steel stringer connector angle designed to receive an offset, channel shaped stringer (by others). A urethane insulated flashing, available in aluminum, copper, or stainless steel, with EPDM Base Seal, completes the assembly. Three models are available to suit different structural and/or size requirements.

Prominent Features: Condensation free. Maintenance free (never needs caulking). Threaded leg assembly provides up to 2" (51 mm) vertical adjustment for leveling if necessary.

Options: PVC coated flashing deck flange for PVC roof membrane. Bituminous painted flashing deck flange for BUR and ModBit roof membrane. Can be combined for use with ARS-102A floating walkway rail roof support or ARS-102A fire route walkway rail roof support. See ARS-510 for alternative metal stair support (Standard Stringer).

RECOMMENDED USE

Suitable for all flat roofs as a metal stair roof support at changes in roof level or other areas to facilitate access for maintenance.

WARRANTY

20 year warranty against leaks, condensation and defects in materials and/or manufacture when installed in accordance with Thaler "Installation Instructions". Copy of Warranty Certificate available upon request.

MAINTENANCE

No maintenance required (maintenance free).

SPECIFICATION (Short Form)

Metal stair roof supports (offset stringer): Thaler [ARS-520] [ARS-520-1] [ARS-520-2] adjustable height, epoxy coated, urethane insulated hollow steel supports including appropriate hardware (adhesive fasteners supplied by others) for fastening to structural roof deck and steel cap/s.s. connector angle designed for affixing steel stair (by others) using s.s. bolts provided; manufacturer's standard urethane insulated [.064" (1.6 mm) mill finish 1100-OT alloy aluminum] [.032" (0.831 mm) 24 oz. copper] [.031" (0.79 mm) 22 ga. Type 304 stainless steel] flashing with EPDM Base Seal and [PVC coated deck flange] [bituminous painted deck flange]; manufactured by Thaler Metal Industries, 1-800-387-7217 (Mississauga, Ontario, Canada) or 1-800-576-1200 (New Braunfels, TX), installed as per manufacturer's written instructions. Provide 20 year warranty against leaks, condensation and defects in materials and/or manufacture.